

N O T I C E

PROPOSED AMENDMENT
For the City of Appleton
OFFICIAL MAP
PUBLIC HEARING

Wednesday, February 6, 2019
7:00 P.M., Council Chambers, City Hall, 100 North Appleton Street

At Which Time Anyone Interested In This Proposal
May Be Heard

The Official Map may be amended to provide for:

The Department of Public Works is requesting to amend the City of Appleton Official Map for the future extensions of N. Kurey Drive and E. Werner Road

WERNER ROAD 66' R/W:

A part of the Northwest ¼ of the Southeast ¼, the Northeast ¼ of the Southwest ¼, the Southeast ¼ of the Southwest ¼ and the Southwest ¼ of the Southwest ¼, of Section 36, Township 22 North, Range 17 East, City of Appleton and the Town of Center, Outagamie County, Wisconsin, containing 5.656 acres of land and being further described by:

Commencing at the South ¼ corner of said Section 36;

Thence South 89°33'20" East 599.27 feet coincident with the South line of the SE ¼ of said Section 36;

Thence North 00°00'00" East 2153.52 feet to the Northerly line of Werner Road at its Westerly terminus per the Glacier Ridge Plat and being the point of beginning;

Thence South 34°07'24" East 66.15 feet (recorded as 66.20 feet) coincident with the Westerly line of Werner Road;

Thence Southwesterly 2.34 feet along the arc of a curve to the left having a radius of 55.00 feet and the chord of which bears South 59°31'50" West 2.34 feet;

Thence South 55°52'37" West 1,036.02 feet;

Thence Westerly 261.11 feet along the arc of curve to the right having a radius of 433.00 feet and the chord of which bears South 73°09'08" West 257.17 feet;

Thence North 89°34'20" West 166.74 feet;

Thence Westerly 280.77 feet along the arc of curve to the left having a radius of 367.00 feet and the chord of which bears South 68°30'39" West 273.98 feet;

Thence South 46°35'38" West 808.76 feet;

Thence Westerly 665.50 feet along the arc of curve to the right having a radius of 866.00 feet and the chord of which bears South 68°36'32" West 649.24 feet;
Thence North 89°22'34" West 531.44 feet to the East line of Meade Street;
Thence North 00°08'12" East 66.00 feet coincident with the East line of Meade Street;
Thence South 89°22'33" East 532.00 feet;
Thence Easterly 614.78 feet along the arc of a curve to the left having a radius of 800.00 feet and the chord of which bears North 68°36'32" East 599.76 feet;
Thence North 46°35'38" East 808.76 feet;
Thence Easterly 331.27 feet along the arc of curve to the right having a radius of 433.00 feet and the chord of which bears North 68°30'39" East 323.25 feet;
Thence South 89°34'20" East 166.74 feet;
Thence Easterly 221.31 feet along the arc of curve to the left having a radius of 367.00 feet and the chord of which bears North 73°09'08" East 217.97 feet;
Thence North 55°52'37" East 1,038.36 feet to the point of beginning.

KUREY DRIVE 66' R/W:

A part of the Northwest $\frac{1}{4}$ of the Northeast $\frac{1}{4}$, the Southwest $\frac{1}{4}$ of the Northeast $\frac{1}{4}$ and the Northwest $\frac{1}{4}$ of the Southeast $\frac{1}{4}$, of Section 36, Township 22 North, Range 17 East, City of Appleton and the Town of Center, Outagamie County, Wisconsin containing 4.6742 acres of land and being further described by:

Commencing at the South $\frac{1}{4}$ corner of said Section 36;
Thence South 89°33'20" East 736.57 feet coincident with the South line of the SE $\frac{1}{4}$ of said Section 36;
Thence North 00°00'00" East 2302.79 feet to the Northeasterly line of Kurey Drive at its Northerly terminus per the Glacier Ridge Plat and being the point of beginning;
Thence South 56°05'50" West 76.79 feet;
Thence North 34°07'23" West 85.93 feet;
Thence Northerly 199.79 feet along the arc of curve to the right having a radius of 333.00 feet and the chord of which bears North 16°56'06" West 196.81 feet;
Thence North 00°15'12" East 328.86 feet;
Thence Northerly 232.76 feet along the arc of curve to the right having a radius of 1,533.00 feet and the chord of which bears North 04°36'11" East 232.54 feet;
Thence North 08°57'10" East 421.88 feet;
Thence Northerly 389.43 feet along the arc of curve to the left having a radius of 767.00 feet and the chord of which bears North 05°35'34" West 385.26 feet;
Thence North 20°08'18" West 1,130.22 feet;
Thence Northerly 188.73 feet along the arc of curve to the right having a radius of 533.00 feet and the chord of which bears North 09°59'41" West 187.74 feet;
Thence North 00°08'57" East 123.42 feet;
Thence South 89°51'03" East 66.00 feet;
Thence South 00°08'57" West 123.42 feet;
Thence Southerly 165.36 feet along the arc of curve to the left having a radius of 467.00 feet and the chord of which bears South 09°59'41" East 164.49 feet;
Thence South 20°08'18" East 1,130.22 feet;

Thence Southerly 422.94 feet along the arc of curve to the right having a radius of 833.00 feet and the chord of which bears South 05°35'34" East 418.41 feet;
Thence South 08°57'10" West 421.88 feet;
Thence Southerly 222.74 feet along the arc of curve to the left having a radius of 1,467.00 feet and the chord of which bears South 04°36'11" West 222.53 feet;
Thence South 00°15'12" West 328.86 feet;
Thence Southerly 160.20 feet along the arc of a curve to the left having a radius of 267.04 feet and the chord of which bears South 16°55'59" East 157.80 feet;
Thence South 34°07'23" East 33.02 feet;
Thence Southeasterly 21.26 feet along the arc of a curve to the left having a radius of 85.19 feet and the chord of which bears South 41°15'31" East 21.20 feet;
Thence South 48°22'00" East 33.19 feet to the point of beginning.

OFFICIAL MAP

WERNER ROAD AND KUREY DRIVE: Being a part of the NW 1/4 of the NE 1/4, SW 1/4 of the NE 1/4, NW 1/4 of the SE 1/4, NE 1/4 of the SW 1/4, SE 1/4 of the SW 1/4 and the SW 1/4 of the SW 1/4 of Section 36, Township 22 North, Range 17 East, City of Appleton and Town of Center, Outagamie County, Wisconsin.

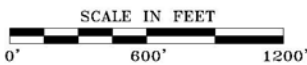
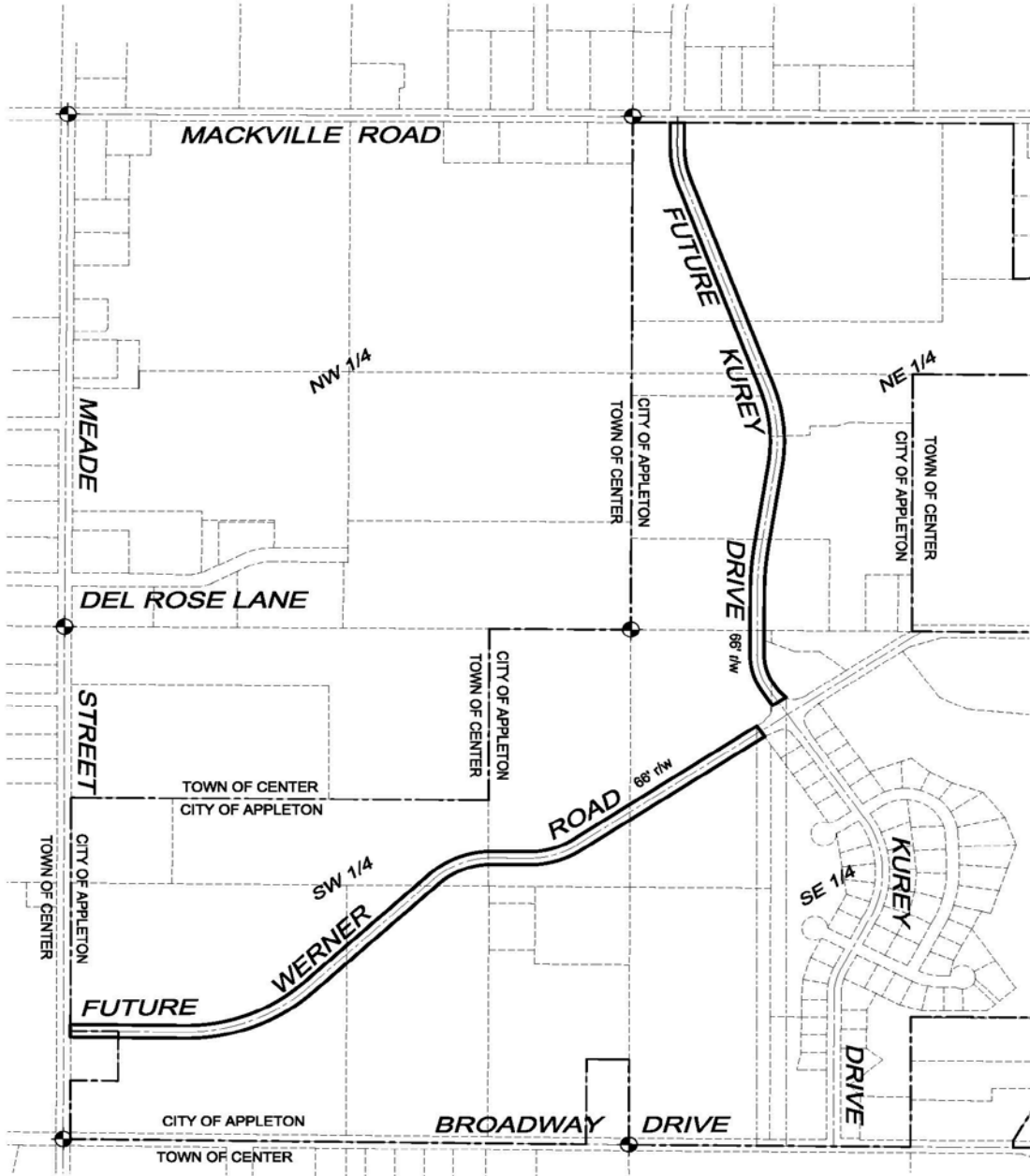

CITY OF APPLETON

DEPT. OF PUBLIC WORKS
ENGINEERING DIVISION
100 NORTH APPLETON STREET
APPLETON, WI 54911

DRAFTED BY: T. KROMM
H:\Acad\Official Map\KureyDr_WernerRd_2018

January 9, 2019

Kami Lynch
City Clerk

RUN: January 22, 2019
January 29, 2019

REASONABLE ACCOMMODATIONS FOR PERSONS WITH DISABILITIES WILL BE MADE UPON
REQUEST AND IF FEASIBLE.