



MEMORANDUM

“...meeting community needs...enhancing quality of life.”

TO: Dean Gazza, Director of Parks, Rec, Facilities and Grounds

FROM: Jessica Titel, Principal Planner

DATE: October 6, 2020

RE: Request to Install Lion Statue within Lions Park

The Appleton Public Arts Committee met on October 6, 2020 and recommended approval of the request from the Appleton Noon Lion’s Club to install a lion statue on City-owned property located within Lions Park at 1920 S. Matthias Street (Tax Id #31-4-5858-01) near the existing park sign at the corner of E. Calumet Street and S. Matthias Street **as shown on the attached maps and subject to the following conditions.**

1. Agreement between the applicant and the City will be prepared by the City’s Legal Services Department and shall be executed prior to installation. This agreement will memorialize the expectations of the parties including the location of the art, installation and insurance requirements, maintenance, liability, indemnification, and the like.
2. Per the Art in Public Places Policy, any artwork signage shall meet the parameters set forth in Zoning Code Section 23-531(e), which allows each artwork one plaque/sign not to exceed nine square feet in size.
3. Applicant and/or any contractors shall provide proof of minimum liability insurance to meet City requirements, prior to installation.
4. Upon completion of the installation, a structural/professional engineer shall provide certification that the artwork was installed according to specifications and meets required structural standards.
5. The applicant shall coordinate with Parks, Recreation and Facilities Management to determine the exact location of the sculpture.

Per the Art in Public Places Policy, the recommendation from the Appleton Public Arts Committee is forwarded to the committee of jurisdiction, in this case, the Parks and Recreation Committee. Please place this item on the agenda for the October 12, 2020 Parks and Rec Committee agenda. Their recommendation would then be forwarded to the Common Council for final consideration on October 21, 2020.

The Staff Report prepared for the Public Art Committee is attached as reference.



REPORT TO PUBLIC ARTS COMMITTEE

Appleton Public Arts Committee Meeting Date: October 6, 2020

Parks & Recreation Committee Date: October 12, 2020

Common Council Meeting Date: October 21, 2020

Item: Lion Statue – Lion’s Park

Case Manager: Jessica Titel

GENERAL INFORMATION

Applicant: Appleton Noon Lion’s Club c/o Mary Beth Nienhaus

Property Owner: City of Appleton c/o Dean Gazza, Director of Parks, Recreation and Facilities Management

Address/Parcel: Lion’s Park - 1920 S. Matthias Street (Tax Id #31-4-5858-01)

Applicant’s Request: Applicant is requesting to place a lion statue within the Lion’s Park.

PROJECT DETAILS

Brief Description of Project and Location: The applicant is proposing to install a lion statue within Lion’s Park. The statue will be placed on a cement slab in the southwest corner of the park, near the existing park sign. The existing planter box around the sign will be expanded to include the newly placed lion. The lion will be owned and maintained by the Noon Lion’s Club.

Reason for Choosing the Proposed Location: The Lion’s Club has been involved in the development of Lion’s Park for many years. The opportunity for the Lion’s Club to acquire the lion from another entity was presented to the Lion’s Club and they approached the City regarding placing the lion statue in Lion’s Park.

Description of How the Work is Installed/Anchored/Attached: The statue will be placed on a concrete slab. Engineering specifications are attached.

Timeline and Duration of Installation: Exact installation dates to be determined, with hopes to install the statue before the end of 2020.

Maintenance and Cost: The statue will be maintained by the Lion’s Club. A public art agreement will be prepared by the City’s Legal Services Department and will need to be executed prior to installation.

Associated Signage: No signage presented at this time. Per the Art in Public Places Policy, any artwork signage shall meet the parameters set forth in Zoning Code Section 23-531(e), which allows each artwork one plaque/sign not to exceed nine square feet in size.

Lion Statue – Lion’s Park

October 6, 2020

Page 2

Appleton Comprehensive Plan 2010-2030: The City of Appleton *Comprehensive Plan 2010-2030* illustrates the importance of the arts community to Appleton and encourages the expansion and promotion of placemaking and arts in the City. The proposed public art project is consistent with the following goals and objectives of the *Comprehensive Plan 2010-2030*.

Chapter 3 – Community Vision #12: Creative place making and public art enhance the public realm and contribute to a vibrant economy.

Goal 7 – Agricultural, Natural, and Cultural Resources

Appleton will continue to protect and enhance its environmental quality and important natural resources, preserve historic sites, and support cultural opportunities for community residents.

RECOMMENDATION

Based upon the guidelines outlined in the Art in Public Places Policy, staff recommends that the proposed installation of the lion statue within Lion’s Park (1920 S. Matthias Street, Tax Id #31-4-5858-01), as shown on the attached maps, **BE APPROVED** subject to the following conditions:

1. Agreement between the applicant and the City will be prepared by the City’s Legal Services Department and shall be executed prior to installation. This agreement will memorialize the expectations of the parties including the location of the art, installation and insurance requirements, maintenance, liability, indemnification, and the like.
2. Per the Art in Public Places Policy, any artwork signage shall meet the parameters set forth in Zoning Code Section 23-531(e), which allows each artwork one plaque/sign not to exceed nine square feet in size.
3. Applicant and/or any contractors shall provide proof of minimum liability insurance to meet City requirements, prior to installation.
4. Upon completion of the installation, a structural/professional engineer shall provide certification that the artwork was installed according to specifications and meets required structural standards.
5. The applicant shall coordinate with Parks, Recreation and Facilities Management to determine the exact location of the sculpture.

Public Art Committee
Lion Statue
Lion's Park
Zoning Map

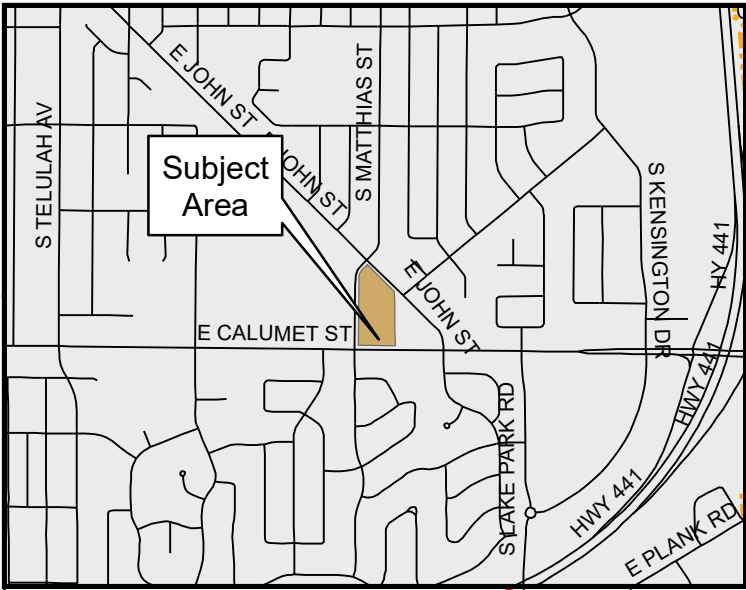

Subject Area

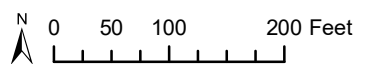
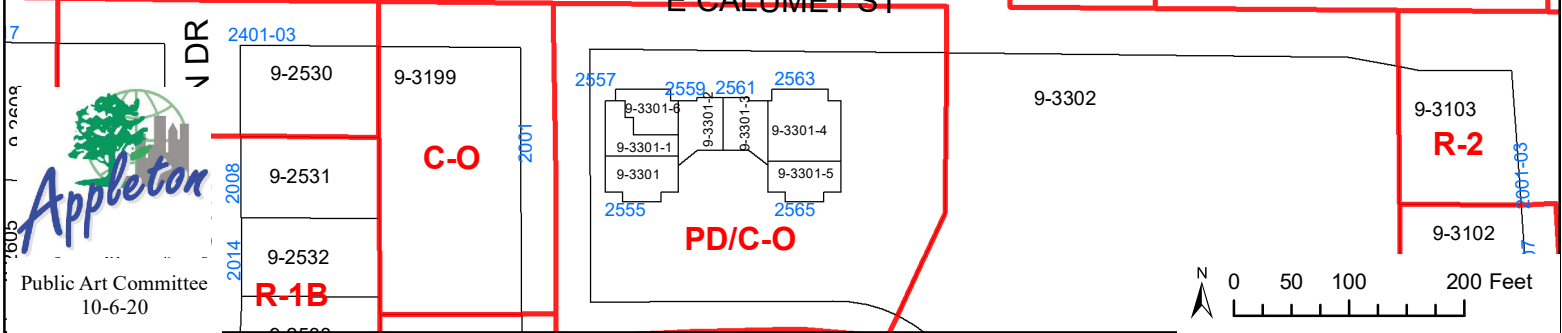
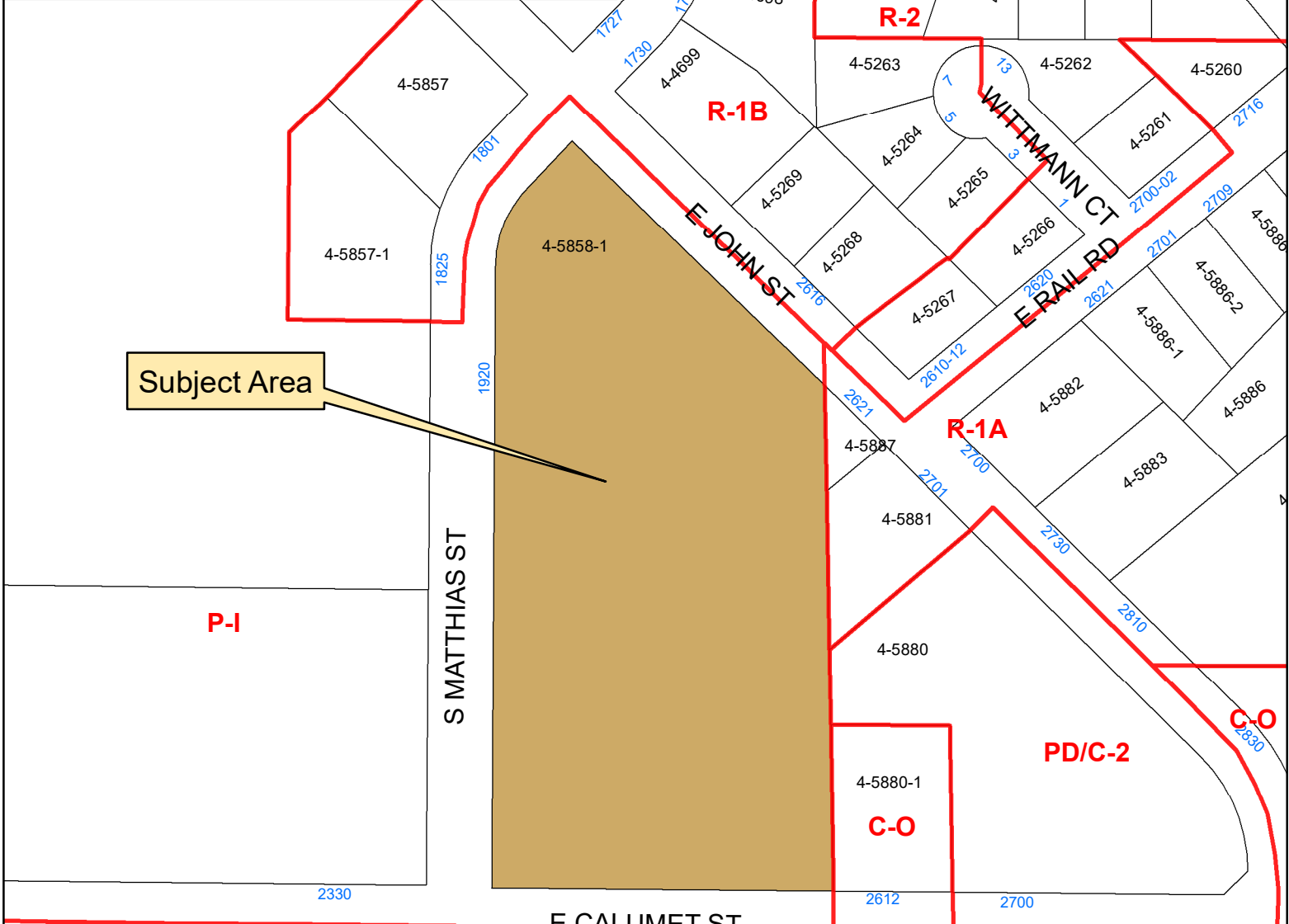

Public Art Committee
Lion Statue
Lion's Park
Aerial Map



Subject Area

Approximate location
of Lion next to planter

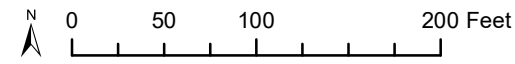

- LION TO BE PLACED BY SIGN

27" WIDE, 50" HT, 97" LENGTH

- PLACED ON CEMENT SLAB

27" WIDE, 80" LONG

- PHOTO ATTACHED TO EMAIL - FAX

- LION PARK

- CEMENT SLAB & 4 FEET OF

LION SECURED TO CEMENT

- HOPEFULLY, ONCE APPROVED THE

LION WILL BE PLACE THIS SUMMER,

- JUNE, JULY

- LIONS CLUB WILL CONTINUE TO

REFURBISH WHEN NECESSARY.



Approximate
location of Lion



STRUCTURAL NOTES

1.0 GENERAL

- 1.1 THE FOLLOWING GENERAL AND SPECIFIC NOTES APPLY EQUALLY TO ALL CONTRACTORS, SUBCONTRACTORS AND SUPPLIERS ENGAGED IN THE WORK SHOWN ON THESE PLANS. THESE NOTES SUPPLEMENT AND ARE MADE A PART OF THE CONTRACT DOCUMENTS.
- 1.2 ALL CONSTRUCTION SHALL BE EXECUTED IN CONFORMANCE WITH THE FOLLOWING:
 - PLANS AND SPECIFICATIONS
 - STATE OF WISCONSIN BUILDING AND SAFETY CODES
 - GOVERNING LOCAL AND MUNICIPAL CODES
- 1.3 DO NOT SCALE DRAWINGS. DRAWINGS ARE OFTEN PRINTED OR REPRODUCED CAUSING INACCURACIES IN SCALED DIMENSIONS. STANDARD DETAILS MAY APPLY AT MULTIPLE CONDITIONS WHERE CERTAIN DIMENSIONS MAY VARY AND ARE CALLED OUT ON THE PLANS OR IN SCHEDULES.
- 1.4 DESIGN LOADS (IBC/WECBC 1607):
SCULPTURE WEIGHT _____ 400 LBS (APPROX)

2.0 SUBSURFACE PREPARATION

- 2.1 THESE SUBSURFACE PREPARATION NOTES DO NOT CONSTITUTE A COMPLETE SITE WORK SPECIFICATION. REFERENCE THE PROJECT MANUAL AND THE GEOTECHNICAL REPORT(S) FOR MORE INFORMATION. CONTRACTOR SHALL BE THOROUGHLY FAMILIAR WITH THE SUBSURFACE CONDITIONS PRIOR TO COMMENCING WITH SITE WORK.
- 2.2 FOUNDATION SLAB HAS BEEN DESIGNED USING AN ASSUMED SAFE NET SOIL BEARING CAPACITY OF 500 PSF. IF ON-SITE GEOTECHNICAL INVESTIGATIONS SHOULD YIELD SAFE BEARING CAPACITIES LESS THAN THIS, CONTACT IONIC STRUCTURES AND DESIGN LLC IMMEDIATELY TO RE-EVALUATE SLAB DESIGN.
- 2.3 NO HOLES, TRENCHES OR DISTURBANCES OF THE SOIL SHALL BE ALLOWED WITHIN THE VOLUME DESCRIBED BY A 45° SLOPE FROM THE BOTTOM EDGE OF THE FOOTING. IF SUCH ARE REQUIRED, THE FOOTING MUST BE LOWERED. CONTACT IONIC STRUCTURES AND DESIGN LLC IMMEDIATELY TO DISCUSS REVISIONS TO THE FOUNDATION PLAN.
- 2.4 NO PIPING, CONDUIT, OR OTHER UTILITIES SHALL BE ALLOWED TO PASS BENEATH FOOTINGS. IF SUCH ARE PRESENT OR REQUIRED, THE FOOTING MUST BE LOWERED. CONTACT IONIC STRUCTURES AND DESIGN LLC IMMEDIATELY TO DISCUSS REVISIONS TO THE FOUNDATION PLAN.
- 2.5 ALL NON-COHESIVE SOILS SHALL BE THOROUGHLY COMPACTED PER THE INSTRUCTIONS OF THE GEOTECHNICAL ENGINEER PRIOR TO THE PLACEMENT OF FOOTINGS.

3.1 REINFORCED CONCRETE

- 3.1.1. REINFORCED CONCRETE SHALL BE DESIGNED, MANUFACTURED AND CAST IN CONFORMANCE WITH THE FOLLOWING STANDARDS:
 - ACI 301 SPECIFICATIONS OF STRUCTURAL CONCRETE FOR BUILDINGS
 - ACI 318 BUILDING CODE REQUIREMENTS FOR REINFORCED CONCRETE
 - ACI 117 SPECIFICATIONS AND TOLERANCES FOR CONCRETE CONSTRUCTION AND MATERIALS
 - ACI 315 MANUAL OF STANDARD PRACTICE FOR DETAILING REINFORCED CONCRETE STRUCTURES
- 3.1.2. MINIMUM CONCRETE COMPRESSIVE STRENGTHS (F'c) AT 28 DAYS:
EXTERIOR SLABS ON GRADE _____ 4,500 PSI
- 3.1.3. CONCRETE EXPOSED TO EARTH OR WEATHER SHALL BE AIR ENTRAINED.
- 3.1.4. ALL SLABS ON GRADE SHALL BE REINFORCED WITH:
 - A. MARCOFIBER OR MARCOFIBER/MICROFIBER BLEND OR
 - B. 6x6-W2.9xW2.9 WELDED WIRE FABRIC UNLESS OTHERWISE NOTED ON THE PLAN. PLACE REINFORCING MESH ONE-THIRD OF THE SLAB THICKNESS BELOW THE TOP SURFACE OF THE SLAB, WITH A MINIMUM COVER OF 1 1/2".
- 3.1.5. FORM 3/4-INCH BEVELS AT ALL CONCRETE EDGES UNLESS SHOWN OTHERWISE.
- 3.1.6. CONCRETE CONTRACTOR SHALL NOTIFY ENGINEER AT LEAST 48 HOURS PRIOR TO CASTING CONCRETE.
- 3.1.7. HOT WEATHER CONCRETING:
 - CONTRACTOR TO FOLLOW PROCEDURES SET FORTH BY ACI 305 "HOT WEATHER CONCRETING" WHEN THE MAXIMUM DAILY TEMPERATURE EXCEEDS 85°F OR WHEN RAPID DRYING/EVAPORATION CONDITIONS EXIST.
- 3.1.8. COLD WEATHER CONCRETING:
 - CONTRACTOR TO FOLLOW PROCEDURES SET FORTH BY ACI 306 "COLD WEATHER CONCRETING" WHEN FREEZING CONDITIONS EXIST OR WHEN THE AVERAGE DAILY TEMPERATURE IS BELOW 40°F.

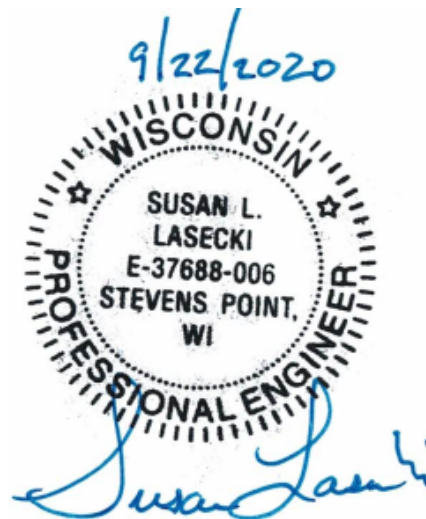
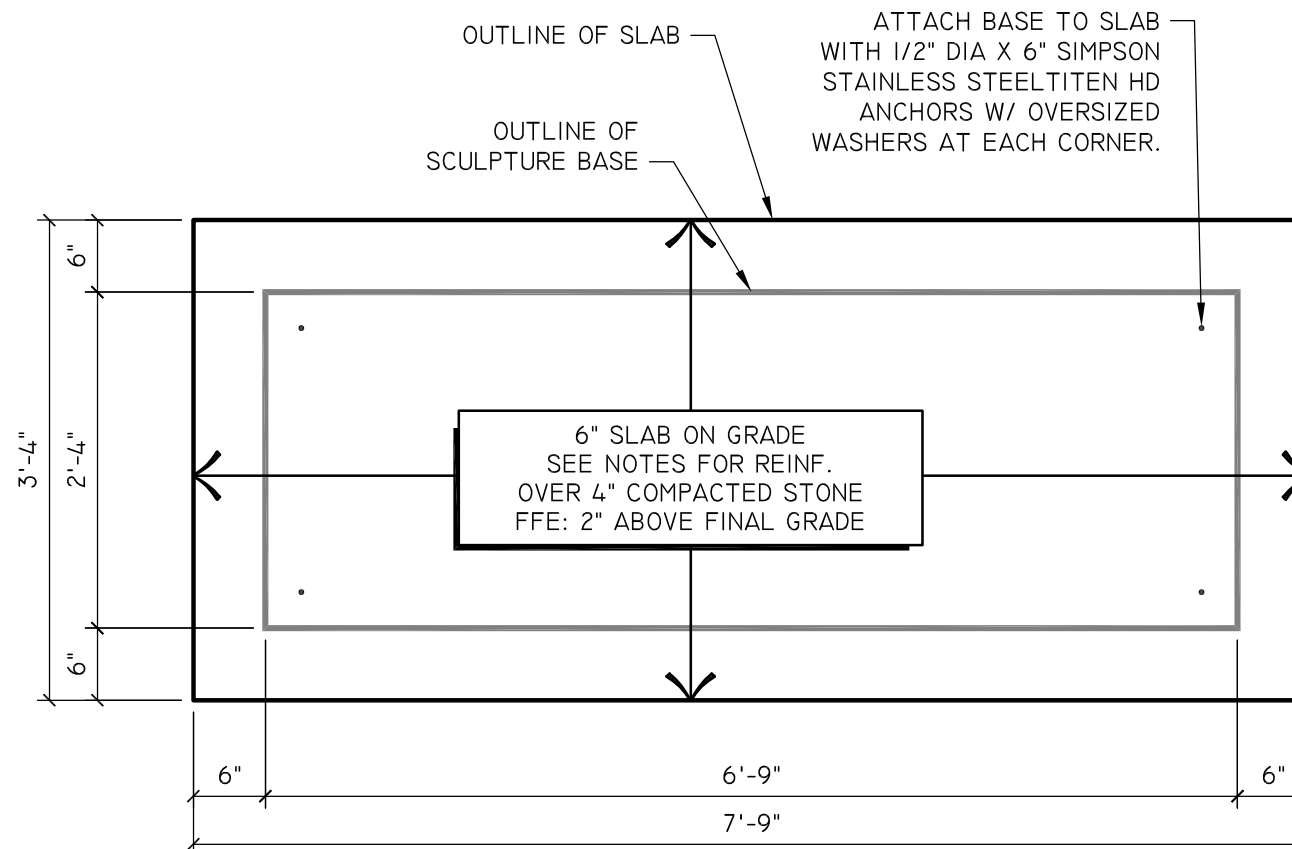

Ionic Structures and Design, LLC
P.O. Box 466
Plover, Wisconsin 54467
(414) 540-8755 Fax: (414) 921-9746
www.ionic-sd.com

CONSULTANTS

PROJECT DATA
LION SCULPTURE BASE
CITY OF APPLETON
APPLETON, WI

DRAWING SET DESCRIPTION

FOR PERMIT & CONSTRUCTION

DATE: 9/19/2020

REVISIONS

DATE	DESCRIPTION

PROJECT No.

20-038

DESIGNED BY: SLL

DRAWN BY: SLL

SHEET TITLE

PLAN & NOTES

SHEET No.

SI