

Southpoint Commerce Park Appleton, Wisconsin

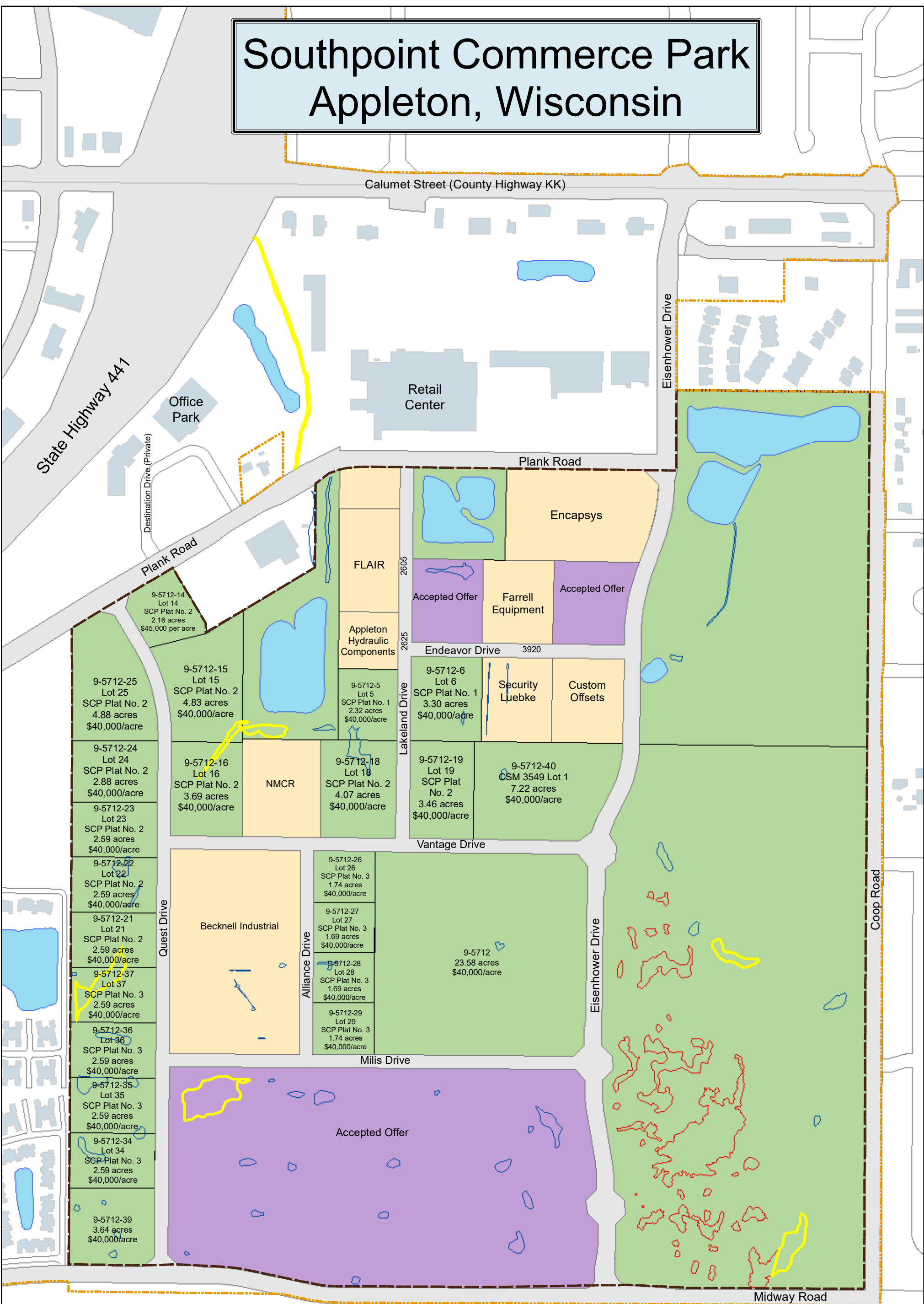

Legend

 For Sale (City Owned)	Wetland Type
 Accepted Offer	 Approximate Wetland for Delineation
 Privately Owned Parcels	 Delineated Wetlands under 10,000 Sq Ft
 City Limits	 Delineated Wetlands over 10,000 Sq Ft
 Park Boundary	

N

0 250 500 1,000

Feet

Prepared by City of Appleton
Comm. & Econ. Dev. Dept. 11/2019