

Paula Vandehey

From: Kurt Craanen
Sent: Monday, June 22, 2020 5:07 PM
To: Paula Vandehey
Subject: Fwd: 4721 N. Meade st.

Paula:

The owner of 4731 N Meade St wants to extend his drive 16 feet. Section 19-91 allows extensions of 12 feet max.

I will send a separate email with map.

Sent from my iPhone

Begin forwarded message:

From: leyton burk <leytonburk@gmail.com>
Date: June 22, 2020 at 4:41:01 PM CDT
To: Kurt Craanen <Kurt.Craanen@Appleton.org>
Subject: 4721 N. Meade st.

Good afternoon

Attached are a couple views of my proposed drive way/ parking addition.

As you stated i will have to get a variance. Please let me know my next move and any other steps I need to take.

Thank you for your time Kurt, it is much appreciated.

Leyton Burk

Attention: This message was sent from a source external to the City of Appleton. Please use caution when opening attachments or clicking links.

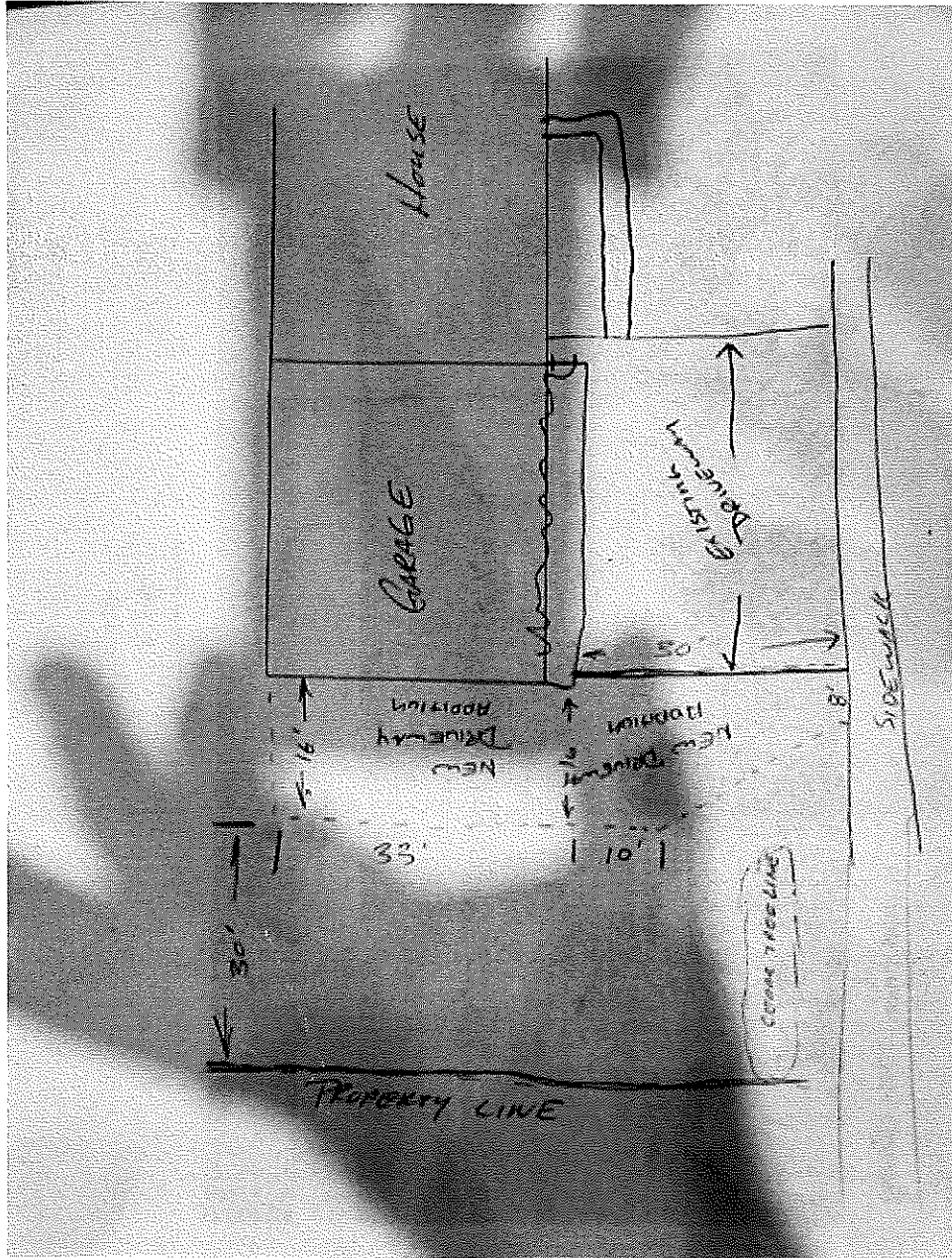

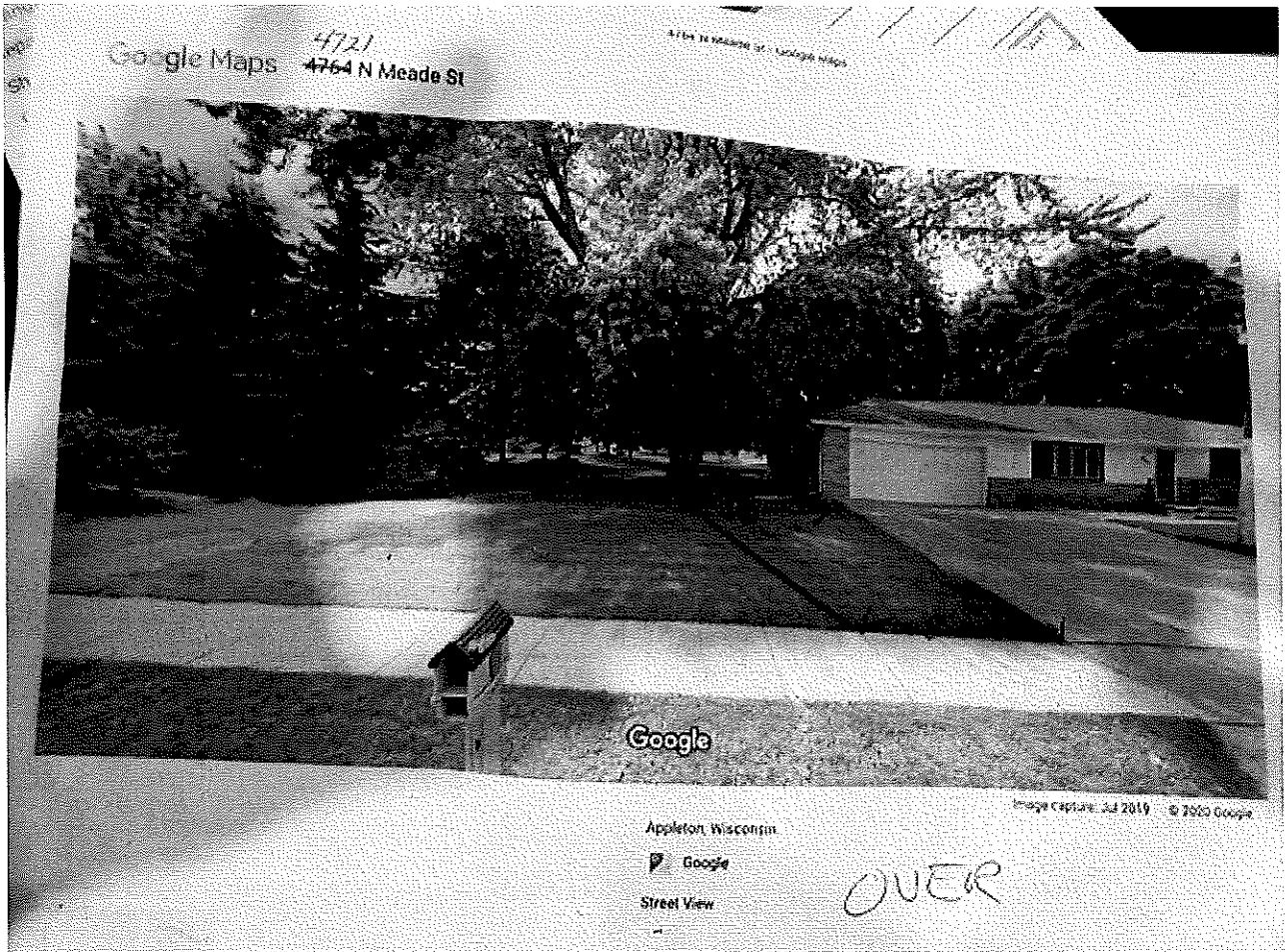

APPLETON CODE

(Code 1965, §10.17(2); Ord 4-93, §1, 1-6-93; Ord 142-93, §1, 9-15-93; Ord 143-93, §1, 9-15-93; Ord 144-93, §1, 9-15-93; Ord 154-93, §1, 9-15-93; Ord 155-93, §1, 9-15-93; Ord 137-95, §1, 12-20-95; Ord 154-01, §1, 9-10-01, Ord 68-05, §1, 5-7-05; Ord 107-05, §1, 1-1-06; Ord 122-05, §1, 1-1-06; Ord 96-10, §1, 6-22-10; Ord 103-10, §1, 1-1-11; Ord 112-12, §1, 10-23-12)

Cross reference(s) - Citation for violation of certain ordinances, §1-17; schedule of deposits for citation, §1-18.

Sec. 19-91. Parking in front and side yard in residential district; parking on terraces.

(a) *Purpose.* The purpose of this section is to clearly define acceptable areas for parking vehicles within the front yard or side yard, as defined in Chapter 23, of private properties in order to address off-street parking issues and maintain the acceptable appearance of City neighborhoods.

(b) *Residential driveway.* Residential driveway means that area leading directly from the street to a garage, carport, or rear yard parking area.

(c) *Front yard.* No person shall park or store any motor vehicle, or recreational vehicle of 26 feet or less, i.e., a "camping trailer", "fifth-wheel trailer", "motor home" or "recreational vehicle" as those terms are defined by §340.01, Stats., as well as boat trailers and boats, utilities trailers, trailered snowmobiles, trailered jet-ski(s) or fishing shanties in the front yard of any residential district except upon a residential driveway and shall be subject to temporary recreational vehicle parking restrictions set forth in §19-92. No recreational vehicle or boat greater than 26 feet in length may be parked or stored in the front yard of any residential district. Any vehicle parked in the front yard, shall be parked within the driveway area in such a manner as to maintain all wheels on the driveway surface, and shall neither obstruct the sidewalk nor extend onto the driveway apron. All driveways on one- (1-) and two- (2-) family residential properties, as well as those properties with three (3) dwelling units, shall be paved with concrete, asphalt, brick or a similar hard surface within one (1) year of construction. Carriage style driveways with a minimum of 2-foot wide strips paved with concrete, asphalt or brick and maintained grass medians in accordance with Sec. 12-59(c)(3) are permitted. Those existing driveways on one- (1-) and two- (2-) family properties, as well as those properties with three (3) dwelling units, that are not currently paved as described for new driveways shall be so paved within one (1) year of notice of non-compliance. (Ord 84-15, §1, 10-27-15)

(d) *Side yard.* No person shall park or store any

motor vehicle, "camping trailer", "fifth-wheel trailer", "motor home" or "recreational vehicle" as those terms are defined by §340.01, Stats., as well as boat trailers and trailered boats, pick-up camper tops, utilities trailers, trailered snowmobiles, trailered jet-ski(s) or fishing shanties in the side yard of any residential district unless the side yard parking area is no greater than twelve (12) feet wide and extends no farther than the rear plane of the principal structure on the property. Side yard parking areas are required to be hard surfaced and subject to the requirements of this section, including the requirement for a permit for the installation of said hard surface.

(e) *Permits.* The Inspections Supervisor shall issue a driveway extension permit or a side yard parking pad permit upon the filing of a proper application, which shall be on a form furnished by the Director and shall describe the nature of the work, material to be used, measurements, plans and/or specifications of the proposed extension as well as such other information as may be required for inspection. Permits shall be issued prior to the start of the work. Fees for this permit shall be kept on file with the City Clerk.

(f) Extensions to the driveway surface, beyond the area previously described in section (d), are permissible provided all of the following apply:

- (1) The property owner has obtained appropriate driveway extension permit; and,
- (2) Both the extension and driveway are paved as provided in sec. (d) above; and,
- (3) The extension is no greater than twelve (12) feet wide; and,
- (4) The paved area is no longer than the length of the driveway, extending from the edge of the City's right-of-way to a carport, rear yard parking area or garage. For the purpose of creating a parking pad, the paved area may extend along the side of the principal structure on the property and may extend to the rear plane of said structure; and,
- (5) Whenever practicable, the extension shall be located on the side of the driveway such that it extends toward the nearest side lot line. When such a configuration is not possible, the property owner may install an extension no greater than four (4) feet into the greater front yard. Any extension into the greater front yard of the property that is more than four (4) feet wide shall require approval from the

TRAFFIC AND VEHICLES

Municipal Services Committee.

- (6) This section shall not apply toward paved circular driveways.
- (7) The paved area shall meet any other requirements of the Municipal Code including, but not limited to, zoning requirements and the Driveway Installation Policy.

(g) Appeals to the requirements of this section shall be filed with the Inspections Supervisor and heard by the Municipal Services Committee. In hearing and deciding appeals, the Committee shall have the power to grant relief from the terms of this section only where there are unusual and practical difficulties or undue hardships due to an irregular shape of the lot, topographical, or other conditions present, as contrasted with merely granting an advantage or convenience. Decisions of the Committee shall be consistent with the purpose and intent of this section.

(h) Relief granted by the Municipal Services Committee, pursuant to (g) above, shall run with the land. (Ord 85-15, §1, 10-27-15)

(i) Any person who shall violate any provision of this chapter shall be subject to a penalty as provided in §1-16 of the Municipal Code. (Code 1965, §10.04(2); Ord 179-02, §1, 8-27-02, Ord 16-05, §1, 2-22-05; Ord 126-06, §1, 10-10-06; Ord 156-10, §1, 10-26-10; Ord 157-10, §1, 10-26-10; Ord 159-10, §1, 11-9-10, Ord 144-11, §1, 6-7-11)

Cross reference(s) - Citation for violation of certain ordinances, §1-17; schedule of deposits for citation, §1-18.

Sec. 19-92. Recreational and commercial vehicle parking and storage in residential district.

(a) **Definitions.** For the purposes of this section, certain terms shall have the meanings ascribed to them in this section, unless the context clearly indicates otherwise.

Recreational vehicle means a "camping trailer", "fifth-wheel trailer", "motor home" or "recreational vehicle" as those terms are defined by §340.01, Stats. It also includes trailers and boats, pick-up camper tops, utilities trailers, trailered snowmobiles, trailered jet-ski(s) or fishing shanties.

- (b) When associated with residential dwellings:

- (1) The outdoor storage of a commercial vehicle or commercial trailer shall be restricted to a vehicle or trailer owned or leased by the occupant(s) of the lot upon which the vehicles are stored.

- (2) The enclosed parking or storage of not more than one (1) commercial or service vehicle rated at Class A – D may be permitted within an attached garage, attached carport, detached garage, and/or detached carport, provided that such vehicle is used by the occupant(s) of the lot upon which the vehicle is parked or stored.

- (3) The outdoor parking or storage of not more than one (1) commercial or service vehicle rated at Class A – D or school bus, may be permitted, provided that such vehicle is parked or stored in the side yard and/or rear yard only and used by the occupant(s) of the lot upon which the vehicle is parked or stored.

- (4) **Recreational vehicle storage.** The outdoor storage of not more than one (1) recreational vehicle in areas other than those addressed in §19-91 may be permitted provided:

- a. Such recreational vehicle is owned or leased by the occupant(s) of the lot upon which the recreational vehicle is stored.
- b. Such recreational vehicle shall not be used for business, living, sleeping, or housekeeping purposes.
- c. Such recreational vehicle shall not be permanently connected to sewer lines, water lines, or electricity.
- d. Such recreational vehicle shall not be used for the storage of goods, materials or equipment not normally a part of or essential to the immediate use in that vehicle or trailer.

- (c) **Recreational vehicle parking in front yard.** Unoccupied recreational vehicles of 26 feet in length or less as defined in §19-92 may be parked in a front yard driveway.

(Code 1965, §11.15(3)(c); Ord 32-92, §1, 3-18-92; Ord 174-93, §1, 10-19-93; Ord 131-96, §1, 12-18-96; Ord 145-11, §1, 6-7-11)