

Southpoint Commerce Park Appleton, Wisconsin

Legend

- For Sale
- Office Use
- Sold
- Park Boundary
- Proposed Parcel Lines
- Proposed Roads
- City Limits

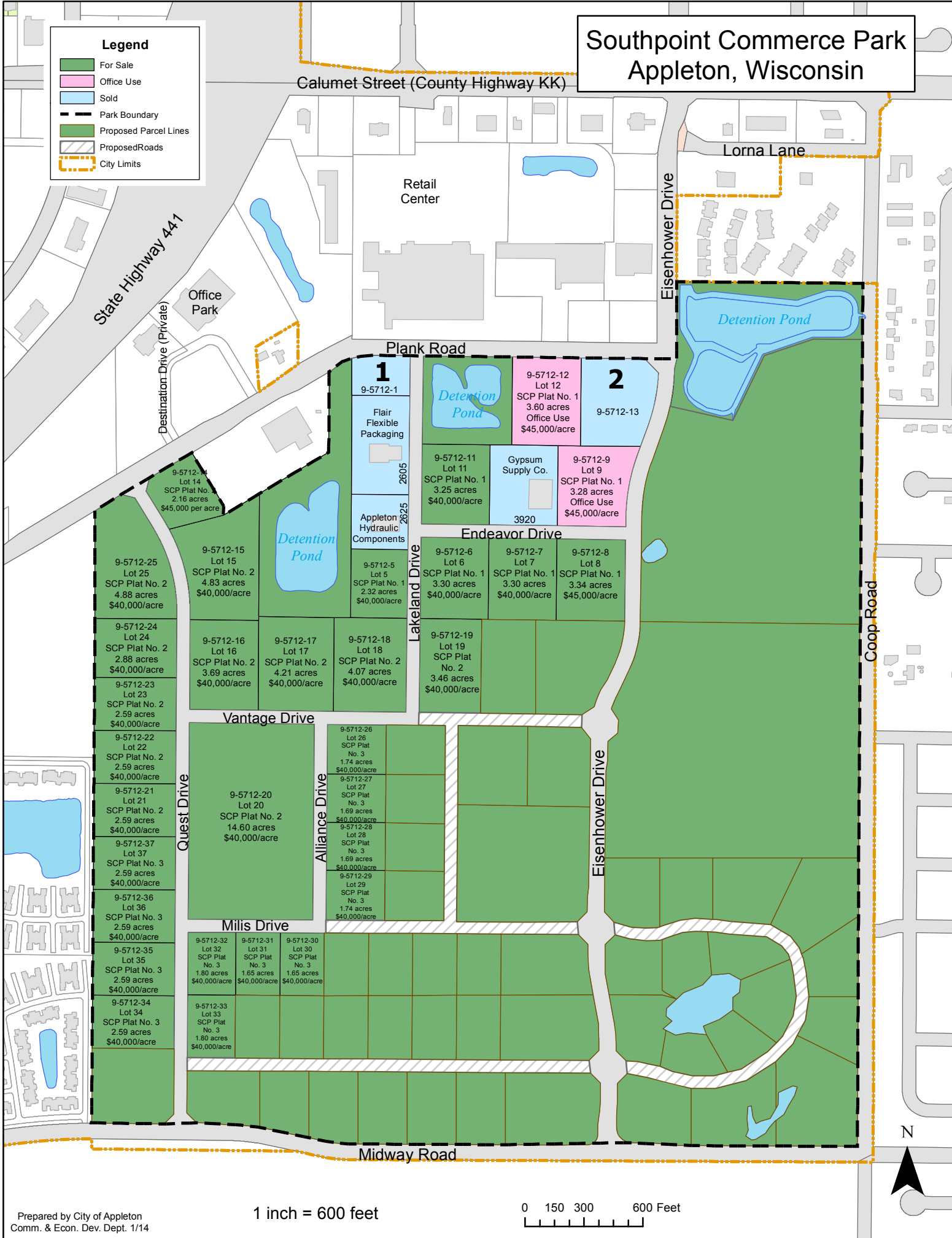

State Highway 441
Destination Drive (Private)
Office Park

Calumet Street (County Highway KK)

Lorna Lane

Retail Center

Eisenhower Drive

Detention Pond

Plank Road

1
9-5712-1

Flair Flexible Packaging

Detention Pond

9-5712-12
Lot 12
SCP Plat No. 1
3.60 acres
Office Use
\$45,000/acre

2
9-5712-13

9-5712-11
Lot 11
SCP Plat No. 1
3.25 acres
\$40,000/acre

Gypsum Supply Co.
3920

9-5712-9
Lot 9
SCP Plat No. 1
3.28 acres
Office Use
\$45,000/acre

Appleton Hydraulic Components

Endeavor Drive

9-5712-6
Lot 6
SCP Plat No. 1
3.30 acres
\$40,000/acre

9-5712-7
Lot 7
SCP Plat No. 1
3.30 acres
\$40,000/acre

9-5712-8
Lot 8
SCP Plat No. 1
3.34 acres
\$45,000/acre

9-5712-25
Lot 25
SCP Plat No. 2
4.88 acres
\$40,000/acre

9-5712-15
Lot 15
SCP Plat No. 2
4.83 acres
\$40,000/acre

9-5712-16
Lot 16
SCP Plat No. 2
3.69 acres
\$40,000/acre

9-5712-17
Lot 17
SCP Plat No. 2
4.21 acres
\$40,000/acre

9-5712-18
Lot 18
SCP Plat No. 2
4.07 acres
\$40,000/acre

9-5712-19
Lot 19
SCP Plat No. 2
3.46 acres
\$40,000/acre

9-5712-24
Lot 24
SCP Plat No. 2
2.88 acres
\$40,000/acre

9-5712-23
Lot 23
SCP Plat No. 2
2.59 acres
\$40,000/acre

9-5712-22
Lot 22
SCP Plat No. 2
2.59 acres
\$40,000/acre

9-5712-21
Lot 21
SCP Plat No. 2
2.59 acres
\$40,000/acre

9-5712-20
Lot 20
SCP Plat No. 2
14.60 acres
\$40,000/acre

Vantage Drive

9-5712-26
Lot 26
SCP Plat No. 3
1.74 acres
\$40,000/acre

9-5712-27
Lot 27
SCP Plat No. 3
1.69 acres
\$40,000/acre

9-5712-28
Lot 28
SCP Plat No. 3
1.69 acres
\$40,000/acre

9-5712-29
Lot 29
SCP Plat No. 3
1.74 acres
\$40,000/acre

Quest Drive

Alliance Drive

Lakeland Drive

Eisenhower Drive

Coop Road

Milis Drive

9-5712-32
Lot 32
SCP Plat No. 3
1.80 acres
\$40,000/acre

9-5712-31
Lot 31
SCP Plat No. 3
1.65 acres
\$40,000/acre

9-5712-30
Lot 30
SCP Plat No. 3
1.65 acres
\$40,000/acre

9-5712-34
Lot 34
SCP Plat No. 3
2.59 acres
\$40,000/acre

9-5712-33
Lot 33
SCP Plat No. 3
1.80 acres
\$40,000/acre

Midway Road

