

**NOTICE OF INFORMAL PUBLIC HEARING**  
**OF THE**  
**APPLETON CITY PLAN COMMISSION**

NOTICE IS HEREBY GIVEN THAT a request to amend the City of Appleton Official Map has been initiated by the City of Appleton Department of Public Works and will be presented to the Appleton City Plan Commission in Common Council Chambers, 6th Floor, City Hall, 100 North Appleton Street, on Tuesday, January 8, 2019, at 4:00 P.M., or as soon thereafter as can be heard, in the matter of the City Plan Commission to amend the Official Map described as follows:

**COMMON DESCRIPTION:** The Department of Public Works is requesting to amend the City of Appleton Official Map for the future extensions of N. Kurey Drive and E. Werner Road

**ALDERMANIC DISTRICT:** 7 – Alderperson Kathleen Plank

You are being notified as a policy of the City of Appleton Community and Economic Development Department. This notification invites you to appear before the Appleton City Plan Commission, and you will be given an opportunity to express your views or concerns regarding the above-described request. You may also address the City Plan Commission by letter at the address below. The City Plan Commission makes a recommendation to the Common Council who makes the final decision on the matter.

Any questions regarding this matter should be directed to Jessica Titel, Principal Planner, in the Community and Economic Development Department at 920-832-6476.

CITY PLAN COMMISSION

COMMUNITY & ECONOMIC DEVELOPMENT  
CITY HALL - 100 NORTH APPLETON STREET  
APPLETON, WISCONSIN 54911-4799  
920-832-6468

*Reasonable accommodations for persons with disabilities will be made upon request and if feasible.*

Official Map Amendment  
Future Extension of Kurey Drive  
Future Extension of Werner Road  
Zoning Map

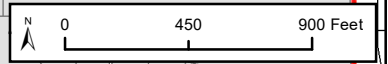
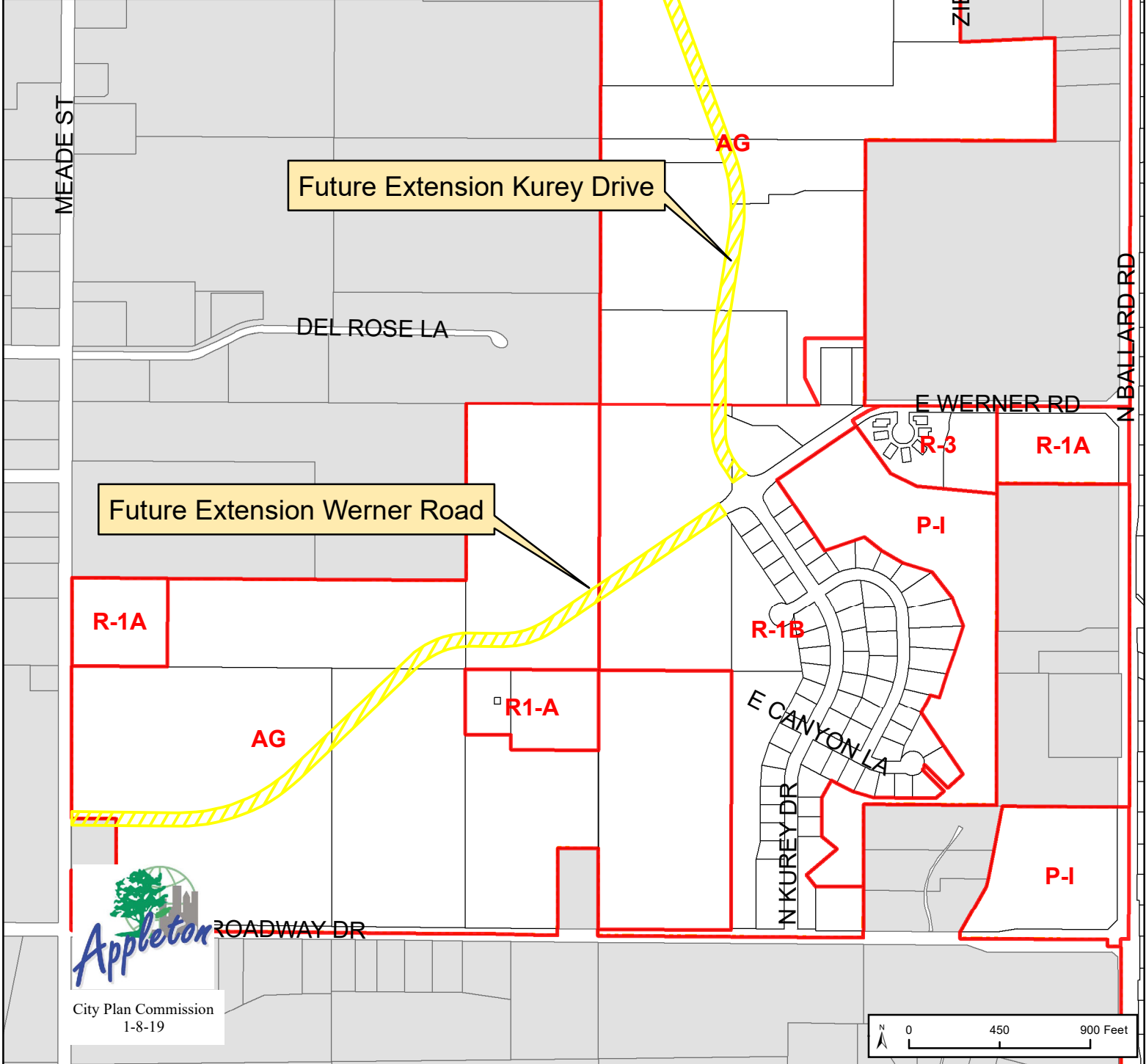
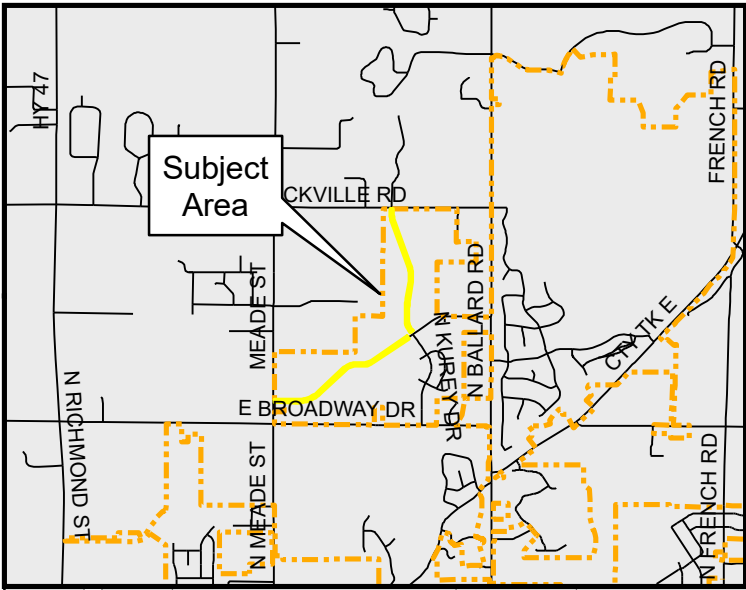

Official Map Amendment  
Future Extension of Kurey Drive  
Future Extension of Werner Road  
Aerial Map



Future Extension Kurey Drive

Future Extension Werner Road

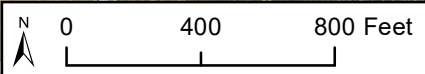

# OFFICIAL MAP

WERNER ROAD AND KUREY DRIVE: Being a part of the NW 1/4 of the NE 1/4, SW 1/4 of the NE 1/4, NW 1/4 of the SE 1/4, NE 1/4 of the SW 1/4, SE 1/4 of the SW 1/4 and the SW 1/4 of the SW 1/4 of Section 36, Township 22 North, Range 17 East, City of Appleton and Town of Center, Outagamie County, Wisconsin.

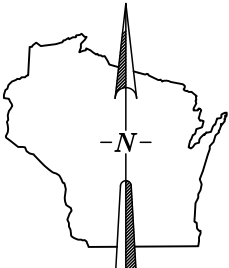
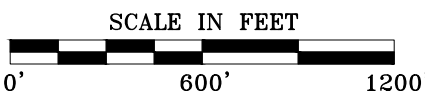
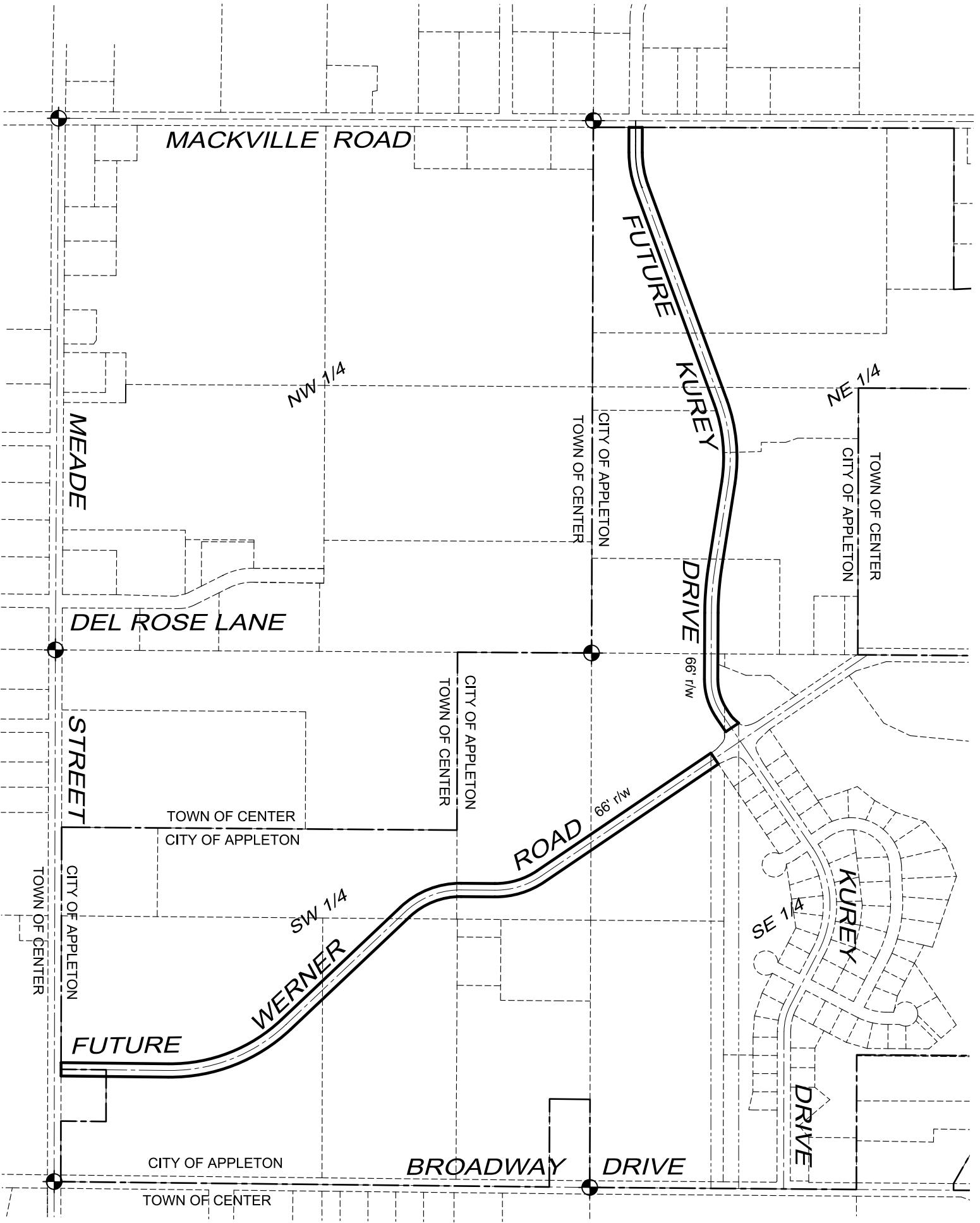

**CITY OF APPLETON**  
DEPT. OF PUBLIC WORKS  
ENGINEERING DIVISION  
100 NORTH APPLETON STREET  
APPLETON, WI 54911  
DRAFTED BY: T. KROMM  
H:\Acad\Official Map\KureyDr\_WernerRd\_2018