

**OPTION 1:
ILLUMINATED PANELS,
ELECTRONIC MESSAGE CENTER**

8'-0" CABINET
7'-8" V.O.

7'-3" MESSAGE CENTER

2'

2'-5" V.O.

3'-1/2" V.O.

3'-5" MESSAGE CENTER

11'-0" CABINET

D/F ILLUMINATED MONUMENT
QUANTITY: (1)

FABRICATED ALUMINUM CABINET
PAINTED SILVER

POLY FACE WITH DIGITALLY PRINTED
AND CUT VINYL GRAPHICS
ILLUMINATED WITH WHITE LEDS
ALUMINUM DIVIDER BAR

POLY FACE WITH TRANSLUCENT
BLUE CUT VINYL GRAPHICS
AND OPAQUE WHITE VINYL DIVIDERS

FULL COLOR MESSAGE CENTER
3'-5" H X 7'-3" W X 8" D
3' H X 7' W VIEWING AREA

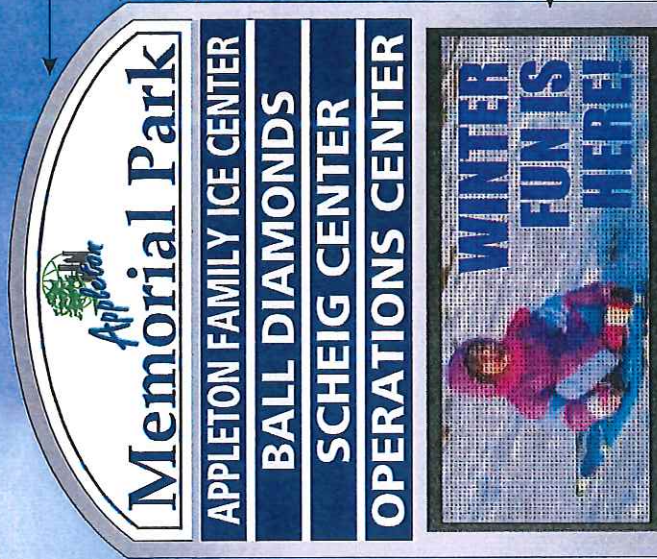

NIGHT VIEW (NOT TO SCALE)

SIDE VIEW

 <p>TLC Sign TRUSTED. LOYAL. CREATIVE. A DIVISION OF TIM'S LIGHTING COMPANY, INC. TLC SIGN.COM</p>	<p>EASTERN WISCONSIN: O: 920-731-4111, F: 920-733-3416 555 ESSENHOWER DR, KIMBERLY, WI 54156</p> <p>CENTRAL WISCONSIN: N7255 32ND CT, WEAUWATIGA, WI 54983 O: 920-867-4111, F: 920-867-3625</p>	<p>CLIENT: CITY OF APPLETON-MEMORIAL PARK PG: 1 OF 2</p> <p>ADDRESS: APPLETON, WI</p> <p>DATE: 02.06.12</p> <p>FILE NAME: 12-00121.CDR</p> <p>REVISED BY: DAN</p>	<p>DESIGNER: KRISTY STACY</p> <p>SCALE: 3/8"=1'-0"</p> <p>REV. DATE: 1.7.16</p>	<p>NOTES:</p>	<p>CUSTOMER SIGNATURE FOR DESIGN APPROVAL</p>
	<p>THIS IS AN ORIGINAL DRAWING CREATED BY TIM'S LIGHTING COMPANY, INC. NO PART OF THIS DOCUMENT MAY BE USED OR REPRODUCED IN ANY FORM WITHOUT WRITTEN PERMISSION FROM TIM'S LIGHTING COMPANY, INC. COLORS SHOWN ON ART MAY VARY DUE TO VARYING SURFACE MATERIALS AND PAINT.</p>				

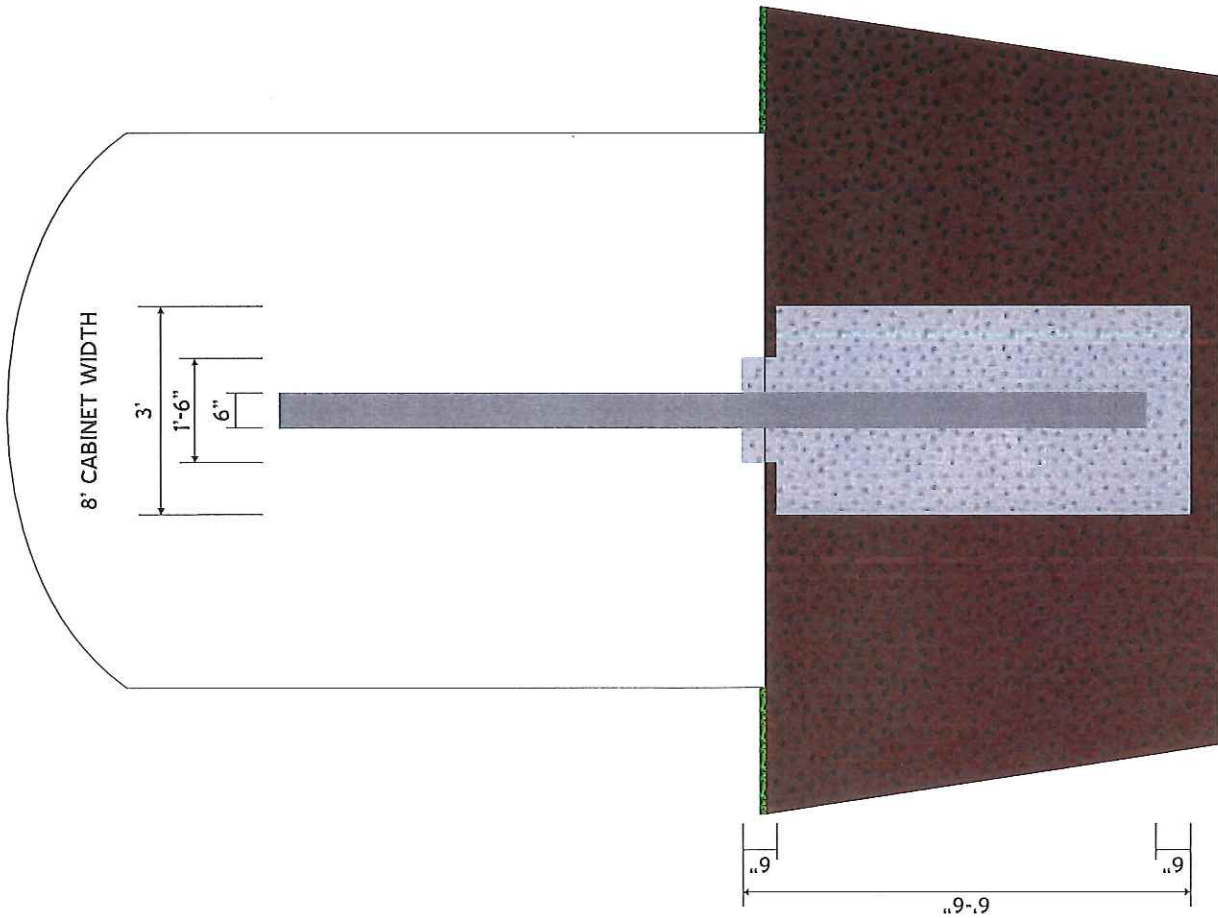

8' CABINET WIDTH

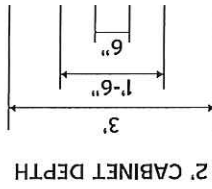
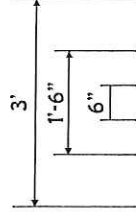

2' CABINET DEPTH

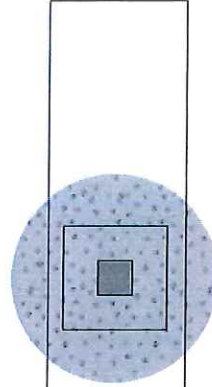

TOP VIEW

DIRECT EMBEDMENT POLE AND CONCRETE FOUNDATION

<p>Eastern Wisconsin: O: 920-731-4111 F: 920-733-3448 555 EISENHOWER DR. KIMBERLY, WI 54136</p> <p>Central Wisconsin: N7255 32ND CT. WEYAUWEGA, WI 54983 O: 920-867-4111 F: 920-867-3625</p>	<p>CLIENT: CITY OF APPLETON-MEMORIAL PARK</p> <p>ADDRESS: APPLETON, WI</p> <p>DATE: 02.06.12</p> <p>FILE NAME: 12-00121.CDR</p>	<p>PG: 2 OF 2</p>	<p>NOTES:</p> <p>DESIGNER: DAN LUKASZEWSKI</p> <p>SCALE: 3/8"=1'-0"</p> <p>REV. DATE: 3.3.16</p>
<p>TLC Sign</p> <p>TRUSTED. LOYAL. CREATIVE. A DIVISION OF TIM'S LIGHTING COMPANY, INC.</p> <p>TLC SIGN .COM</p>	<p>CUSTOMER SIGNATURE FOR DESIGN APPROVAL</p> <p>THIS IS AN ORIGINAL DRAWING CREATED BY TIM'S LIGHTING COMPANY, INC. NO PART OF THIS DOCUMENT MAY BE USED OR REPRODUCED IN ANY FORM WITHOUT WRITTEN PERMISSION FROM TIM'S LIGHTING COMPANY, INC. COLORS SHOWN ON ART MAY VARY DUE TO VARYING SURFACE MATERIALS AND PAINT.</p>		





ELEC WR **WI3899162**
 GAS WR _____

CITY/TOWN/VILLAGE: C - APPLETON
 CUST/PROJ NAME: CITY OF APPLETON
 PROJECT LOCATION: WITZKE RD AND BALLARD
 WORK DESCRIPTION: NEW 200A DB SERVICE TO SIGN

PREPARED BY: HEATH HEMAUER
 E-MAIL: HEATH.HEMAUER@WE-ENERGIES.COM
 OFFICE #: 920-380-3355 CELL #: _____
 PAGER #: _____ IO #: 5469
 PROJECT ID: _____ CGS #: _____
 DATE PREPARED: 2/24/2016 DATE REVISED: _____

COMMON INFORMATION

STAKING REQUIREMENTS:

- SURVEYOR STAKED
 DESIGNER NOT NEEDED

MAIN / SERVICE IN EASEMENT:

- YES NO

RESTORE PRIVATE PROPERTY: WE ENERGIES CUSTOMER

WORK IS APPROX 50 FT, DIRECTION NW OF CL OF
WITZKE AND BALLARD NEAREST CROSS STREET
(ALSO FOR GAS SERVICE TEE)

ELECTRIC INFORMATION

OPER MAP #: 3888-9044-02 FEEDER/LINE #: FFRR63

CATV JOINT USE #: _____ TEL JOINT USE #: _____

PROPOSED GAS SERVICE INFORMATION

- MTR SIZE: _____ MTR TYPE: _____ PRES: _____ EFV
 SERV PIPE SIZE: _____ MATERIAL: _____ RELIGHT
 MTR LOC: _____ FT. _____ OF _____ CORNER CURB VLV
 CONSTRUCTION TYPE: _____ TIE IN PIPING

JOB INFO:

SECTION / TOWN / RANGE: SE1/4 SEC13, T21N, R17E
 SITE VISIT COMPLETED BY: HEATH HEMAUER
 JOB OWNER: STACY CZAJKOWSKI 920-380-3346



MAIN CONTACTS

- CONTRACTOR/BUILDER:
 PLUMBER/ HVAC:
 ELECTRICIAN: TOM FLICK 920-832-3915
 CUSTOMER:

CONTINGENCIES & COMMENTS:

DIGGERS HOTLINE / MISS DIG REQUIRED.

WE ENERGIES WILL RESTORE

WE ENERGIES WILL HAUL SPOIL

CUSTOMER IS REQUIRED TO LOCATE ALL PRIVATE UNDERGROUND FACILITIES PRIOR TO INSTALLATION.

WE ENERGIES IS NOT RESPONSIBLE FOR ROOT DAMAGE

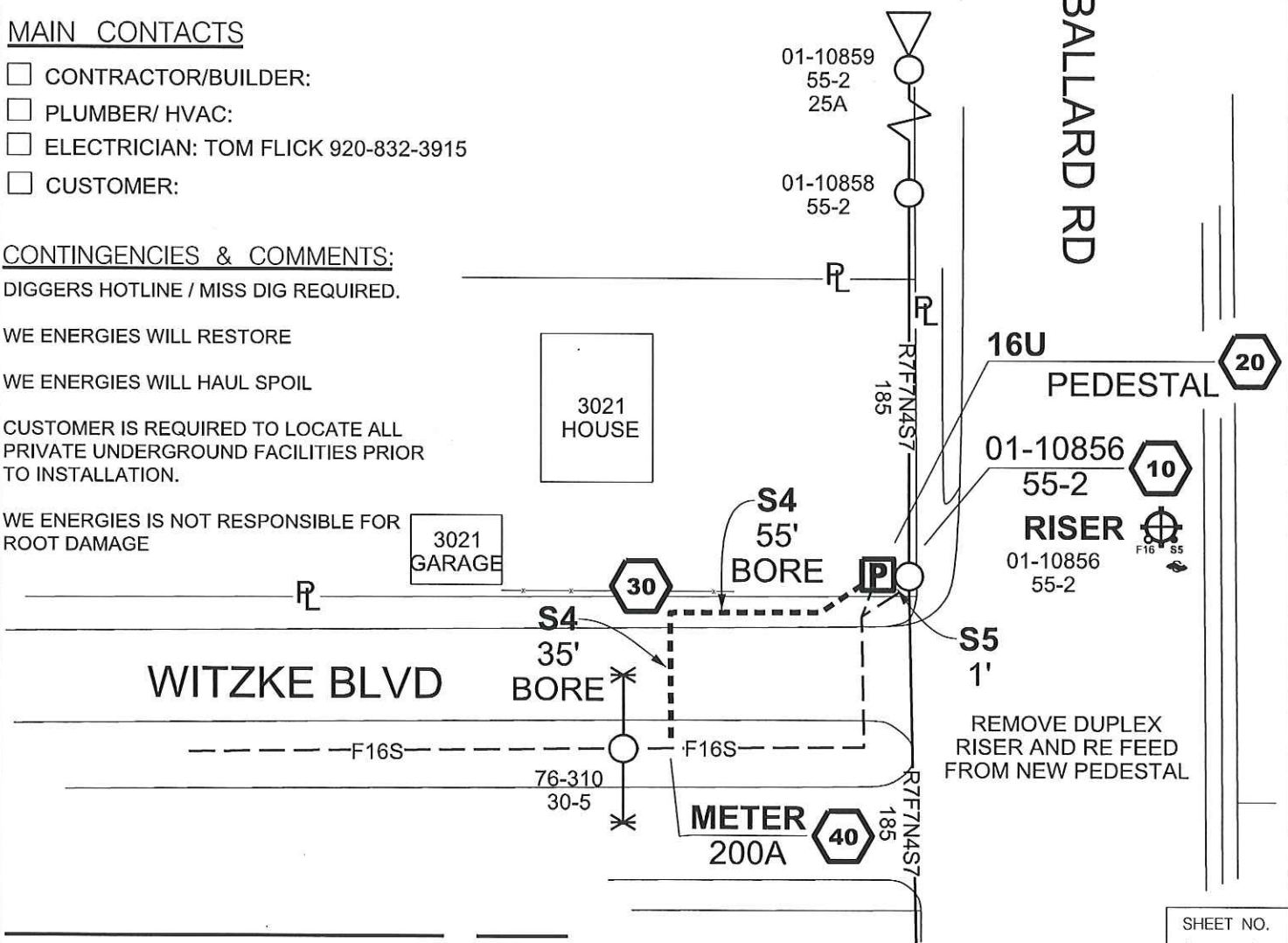

CUSTOMER'S SIGNATURE OF APPROVAL _____ DATE _____

\$DATE\$ \$TIMES\$ \$FILES\$

SHEET NO. **1** OF **1**

Witzke Blvd

Ballard Rd (CTH E)



Proposed LED Sign

