

**Welcome to the City of Appleton's public portal, "My Neighborhood"**

[Return to the City of Appleton homepage](#)  
[Return to the "My Neighborhood" portal homepage](#)

This portal includes general information about schools and garbage pick up days, government information including your governmental districts, local Alderperson and voting location, parcel information, assessment data including sales, values and property taxes, and some detailed information about buildings on that property including a photo in most cases. All of this can be accessed by searching the tax key, the address or even just a portion of the address you are interested in.

**2115 E EVERGREEN DR**



[Click here to view a map of this parcel](#)

**Disclaimer\*\*** Building locations are approximate therefore may appear over the lot line. A private survey is needed to provide exact location of building footprint and lot line.

[Interactive Virtual Neighborhood Tour](#)

This is an interactive mapping application centered near the property. The subject property may not be in the initial view as the application views a Northern direction by design.

Directions for use:

- Drag and drop the street view "car" marker, or click on any street in the street view map.
- Click on the arrows shown on the street centerlines to move up/down the street within the Google Street Image.
- Additionally, each window has navigational controls in the upper left corner.

Property Detail for 31-1-6510-39



**General**

General Information	
<b>**Garbage Day:</b>	Wednesday
<b>* &amp; **Residential Recycle Day:</b>	Wednesday, 06-09-2021
<b>Fall Leaf Collection Dates:</b>	<a href="#">October 18-22</a> , <a href="#">November 1-5</a> , <a href="#">November 15-19</a>
<b>Water Source:</b>	Appleton
<b>Sanitary District:</b>	Appleton
<b>School District:</b>	Appleton Area
<b>Elementary School:</b>	Huntley
<b>Middle School:</b>	Kaleidoscope
<b>High School:</b>	Appleton North
<b>Fire Station Number:</b>	6
<b>Fire Station Address:</b>	4930 N. Lightning Dr
*Please see the City of Appleton homepage for updated holiday pickup schedules.	
**Collection schedule does not apply to apartment complexes <b>with 5 or more units</b> .	

**Voting**

Voting Info	
<b>Polling Location:</b>	<a href="#">Celebration Ministry Center (Faith Lutheran Church)</a>
<b>Alderman:</b>	<a href="#">Sheri Hartzheim</a>
<b>Alderman District:</b>	<a href="#">13</a>
<b>City Ward:</b>	38
<b>County:</b>	<a href="#">Outagamie</a>
<b>County Supervisor District:</b>	22
<b>Assembly District:</b>	<a href="#">56</a>

<b>Senate District:</b>	<a href="#">19</a>
<b>Congressional District:</b>	8
<b>Who Represents Me?:</b>	<a href="#">State &amp; Government Leaders</a>

## Parcel

<b>Parcel Information</b>	
<b>Assessment Class:</b>	COMMERCIAL

<b>Property Owner</b>	
<b>Name</b>	MANOS HOLDINGS NORTH APPLETON LLC
<b>Address</b>	3333 N MAYFAIR RD #311 MILWAUKEE WI 53222

<b>Legal Description Information</b>	
<b>Legal Description</b>	CSM 5372 LOT 1 VOL 31 DOC 1713798 BEING PRT OF LOT 1 OF CSM 5087 AND PRT OF NW1/4 OF N W1/4 SEC18 T21N R18E EXCEPT DOC 1872656 FOR R/W

<b>Land Size</b>	
<b>Frontage/SqFt/Acres</b>	69058.00
<b>Effective Depth</b>	0
<b>Shape</b>	

<b>Zoning Information</b>	
<b>C2</b>	General Commercial District
*Please visit <a href="#">Chapter 23 Zoning</a> in the Municipal Code for additional details or contact Community Development at (920) 832-6468.	

<b>Businesses</b>	
<b>BUSINESS NAME</b>	
DENTAL ASSOCIATES FAMILY AND S	

<b>Other Buildings on this Parcel</b>	
<b>Current Assessed Value</b>	
<b>Land:</b>	\$345,300
<b>Building:</b>	\$1,409,000
<b>Total:</b>	\$1,754,300

<b>2020 Tax Information</b>	
<b>Property Taxes:</b>	\$38,575.96
<b>Special Assesments:</b>	\$0.00
<b>State Credits:</b>	\$2,579.38
<b>Less Lottery Credit:</b>	\$0.00
<b>1st Dollar Credit:</b>	\$56.50
<b>Tax Bill Amount:</b>	\$35,940.08
<b>Amount Collected:</b>	\$35,940.08
<b>Interest Due:</b>	\$0.00
<b>Balance Due:</b>	\$0.00

<b>Sales &amp; Transfers</b>	
<b>DATE:</b>	September 2012
<b>PRICE:</b>	\$1,431,171.00
<b>VALIDITY</b>	RELATED INDIVIDUAL/CORPOR
<b>DOCUMENT #:</b>	1961642
<b>DEED TYPE:</b>	Warranty Deed

**DATE:** May 2010  
**PRICE:** \$0.00  
**VALIDITY** GOVERNMENTAL AGENCY  
**DOCUMENT #:** 1872656  
**DEED TYPE:** Award of Damages

**DATE:** April 2006  
**PRICE:** \$130,000.00  
**VALIDITY** VALID SALE  
**DOCUMENT #:** 1707920  
**DEED TYPE:** Warranty Deed

**DATE:** April 2006  
**PRICE:** \$72,200.00  
**VALIDITY** VALID SALE  
**DOCUMENT #:** 1707922  
**DEED TYPE:** Warranty Deed

**DATE:** March 2006  
**PRICE:** \$329,000.00  
**VALIDITY** VALID SALE  
**DOCUMENT #:** 1704706  
**DEED TYPE:** Warranty Deed

#### Building

**Structure Type:** Clinic  
**Year Built:** 2006  
**Number of Stories:** 1  
**Exterior Wall Type:** 802 - Ashlar Stone Veneer  
**Building Area:** 9746  
**Framing Type:** CONCRETE BLOCK LOAD-BEARI

#### Other Improvements

**Year Built:** 2005  
**Quantity:** 1  
**Description:** COM-SITE IMP ASPHALT PAVING  
**SQFT:** 25000

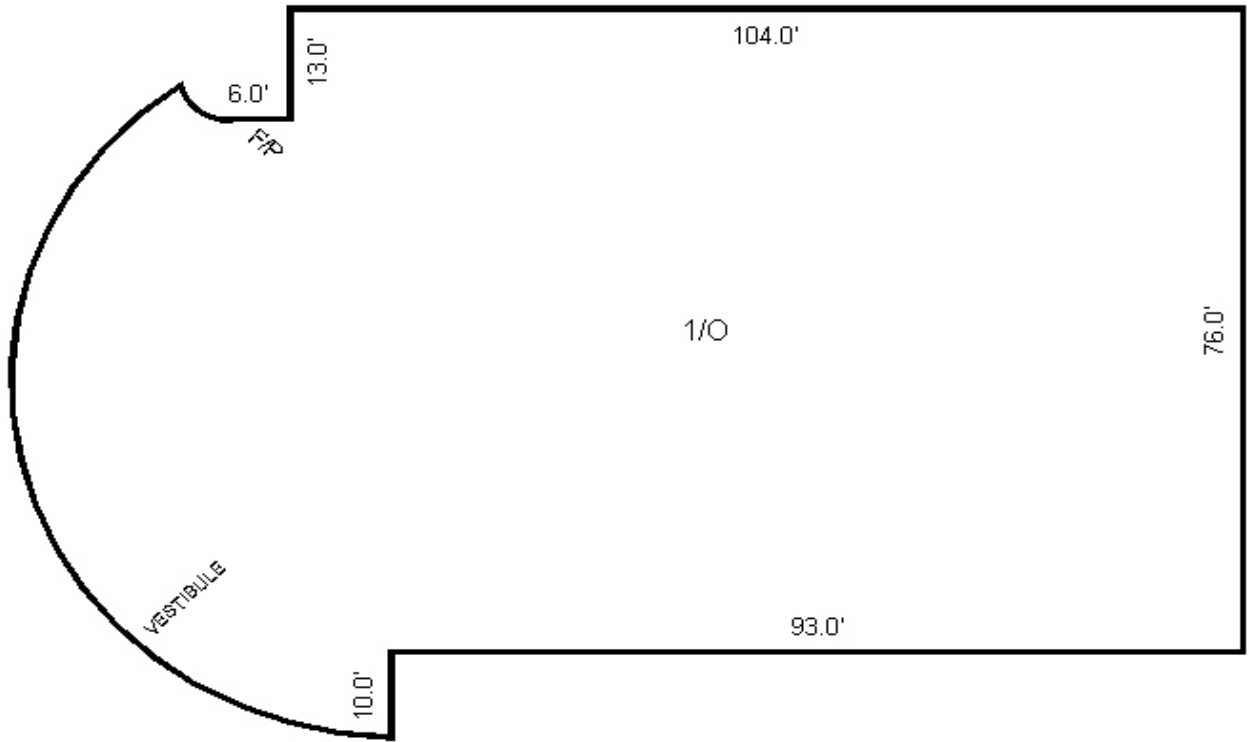

Sketch by Apex IV™