



PERMIT TO OCCUPY THE PUBLIC RIGHT-OF-WAY

Permit #: _____
 Effective Date: _____
 Expiration Date: _____
 Fee: \$40.00
 Paid (yes or no): add to excavation permit

Rev. 04-10-15

Applicant Information

Name (print): GARY LAABS Company: ATT UT#A020xyw
 Address: 221 W WASHINGTON ST Telephone: 920-735-3063 FAX: _____
APPLETON WI 54911 e-mail: GL1784@ATT.COM
 Applicant Signature: GARY LAABS Digitally signed by GARY LAABS Date: 2021.06.11 10:45:23 -05'00' Date: 6/11/2021

Occupancy Information

General Description: PLACE NEW FIBER CABINET ON COMMERCIAL FOR THE PURPOSE OF FEEDING THE
DETAILED AREA PROVIDED WITH FIBER SERVICES
 Street Address: 2018 KERNAN AVE Tax Key No.: _____
 - or -
 Street: KERNAN From: CALUMET To: COOLIDGE AVE
 Multiple Streets: _____

(Department use only)

Occupancy Type	Sub-Type	Location
<input checked="" type="checkbox"/> Permanent (\$40)	<input type="checkbox"/> Sandwich Board	<input type="checkbox"/> Sidewalk
<input type="checkbox"/> Temporary - max. 35 days (\$40)	<input type="checkbox"/> Tables / Chairs	<input type="checkbox"/> Terrace
<input type="checkbox"/> Amenity/Annual (\$40)	<input type="checkbox"/> Dumpster	<input type="checkbox"/> Roadway
<input type="checkbox"/> Blanket/Annual (\$250)	<input type="checkbox"/> POD / Container	
<input type="checkbox"/> Block Party (\$15)	<input type="checkbox"/> Obstruction / Other	

Additional Requirements

Plan/Sketch Certificate of Insurance Bond
 Other: _____

Traffic Control Requirements N/A Contact Traffic Division (832-2379) 1 business day prior to any lane closure, or 2 business days prior to a full road closure.

Type of Street:	Proposed Traffic Control:
<input type="checkbox"/> Arterial/CBD	<input type="checkbox"/> City Manual Page(s)
<input type="checkbox"/> Collector	<input type="checkbox"/> State Manual Page(s)
<input type="checkbox"/> Local	<input type="checkbox"/> Other (attach plan)

Approved by: _____ Date: _____

Additional Requirements: _____

- This permit approval is subject to the following conditions:**
1. Permittee is responsible to obtain any further permits that may be required as part of this occupancy.
 2. Permittee shall adhere to any plan(s) that were submitted to the City of Appleton as part of this application.
 3. This permit is subject to IMMEDIATE REVOCATION and/or issuance of a MUNICIPAL CITATION if conditions of the permit are not met.
 4. This permit is subject to IMMEDIATE REVOCATION if unfavorable traffic conditions develop during the period the occupancy is permitted.
 - 5.
 - 6.

This permit is issued to the applicant upon payment of the permit fee and is expressly limited to the location and type described herein. The applicant, in exchange for receiving this permit, warrants that all street occupancies will be performed in conformity to City ordinances, standards and policies, be properly barricaded and lighted, and be performed in a safe manner. By applying for and accepting this permit, the applicant assumes full liability and/or any costs incurred by the City for corrective work required to bring the subject area into compliance with said ordinances, standards, policies and permit conditions. No occupancy shall occur prior to approval of this permit by the Department of Public Works.

The Grantee shall guarantee at their expense, the repair or replacement of pavement, sidewalk and any other facilities within the public right-of-way damaged or destroyed by the Grantee or any sub-contractor working for them. The Grantee shall assume complete and full liability and responsibility, in accordance with existing ordinances and policies, in the event of injury or damage to persons or property resulting from their facilities within the public right-of-way.

APPROVED BY: _____ DATE: _____
 (Department of Public Works)

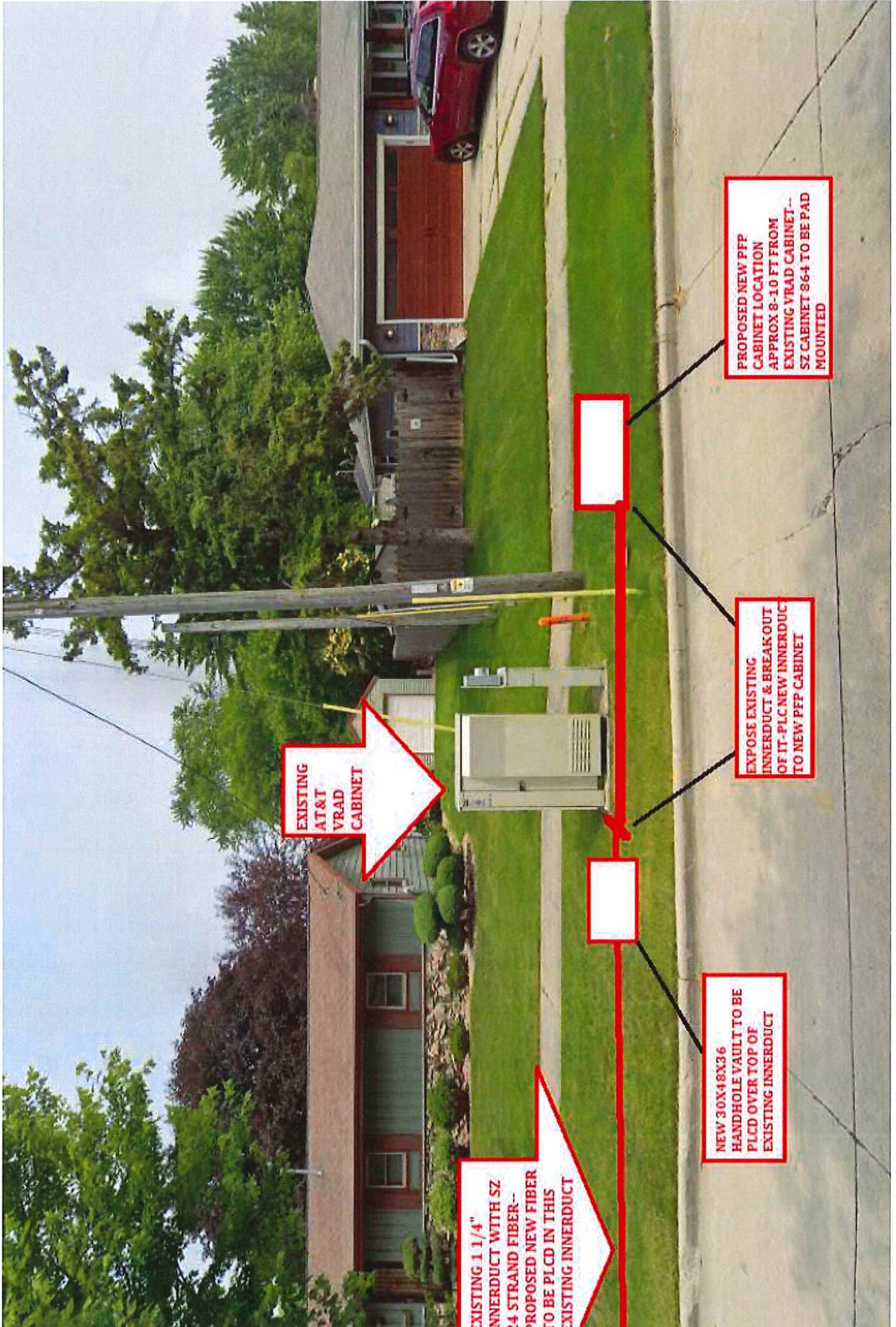

EXISTING 1 1/4"
INNERDUCT WITH SZ
4 STRAND FIBER--
PROPOSED NEW FIBER
TO BE PLCD IN THIS
EXISTING INNERDUCT

EXISTING
AT&T
VRAD
CABINET

NEW 30X48X36
HANDHOLE VAULT TO BE
PLCD OVER TOP OF
EXISTING INNERDUCT

EXPOSE EXISTING
INNERDUCT & BREAKOUT
OF IT-PLC NEW INNERDUCT
TO NEW PFF CABINET

PROPOSED NEW PFF
CABINET LOCATION
APPROX 8-10 FT FROM
EXISTING VRAD CABINET--
SZ CABINET 864 TO BE PAD
MOUNTED

E CALUMET ST



NEW PROPOSED PFP
CABINET LOCATION

S KERNAN AV

1425

2000

2018

5

1331

2013