









← select parcel from results list below to view information  

Features displayed: 1 - 1 / 1

▶ 31-3-0228-00 | 726 S MASON ST



-  Zoom to
-  Pan to
-  Show on map
-  Export all >
-  Export selected >

< 1 > 100 /page ▾

General Information

Garbage Day: Monday
Recycle Day: Monday week of 10/2/2023
Leaf Collection:
Water Source: Appleton
Sanitary District: Appleton
School District: Appleton
Elementary School:
Middle School:
High School:
Fire Station Number: District 3
Fire Station Address: 801 W. Grove St

Building Information

Living Units: 1
Year Built: 1924
Number of Stories: 1.5
Total Living Area: 1176
1st Floor Living Area*: 672
Number of Bedrooms: 3
Number of Full Baths: 1
Number of Half-Baths: 0
Fireplaces:
Basement: Full

*Total Living Area does not include area below grade.

Number of Attached Garages: DETACHED GARAGE - FRAME
Attached Garage Sq. Ft.: 240

Voting Information

Polling Location: [visit MyVote](#)
Aldersperson: Alex Schultz
Aldersperson District: 9
City Ward: 26
County: Outagamie County
County Supervisor District: 19
Assembly District: 57
Senate District: 19
Congressional District: 8

Link to Wisconsin State Legislature:
<https://legis.wisconsin.gov/>

Parcel & Zoning Information

Assessment Class: RESIDENTIAL

Name: JASON LEWANDOSKI
Address: 726 S MASON ST
 APPLETON WI
 54914

Legal Description: FAIRVIEW ADDN 3WD LOT 8
 BLK 1

Frontage/SqFt/Acres: 50
Effective Depth: 150

Zoning: R1B

Assessment & Tax Information

2023 In Process Assessment

Land: \$25,000
 Building: \$144,700
 Total: \$169,700

2022 Tax Information

Property Taxes: \$2,552.64
Special Assessments: \$0
State Credits: \$165.46
Less Lottery Credit: \$-198.09
1st Dollar Credit: \$-60.35
Tax Bill Amount: \$2,294.2

For questions on tax credits, please contact the
 County Treasurer.

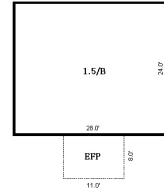

Print by Open 12™

Print

Contact us at gis@appleton.org

City of Appleton Property Search v1.1