



# PERMIT TO OCCUPY THE PUBLIC RIGHT-OF-WAY

Permit #: \_\_\_\_\_  
 Effective Date: \_\_\_\_\_  
 Expiration Date: \_\_\_\_\_  
 Fee: \$40.00  
 Paid (yes or no): add to excavation permit  
21-0516-PW

Rev. 04-10-15

**Applicant Information**

Name (print): GARY LAABS Company: ATT UT#A01YEN0  
 Address: 221 W WASHINGTON ST Telephone: 920-735-3063 FAX: \_\_\_\_\_  
APPLETON WI 54911 e-mail: GL1784@ATT.COM  
 Applicant Signature: GARY LAABS Digitally signed by GARY LAABS  
Date: 2021.06.11 10:45:23 -0500 Date: 6/11/2021

**Occupancy Information**

General Description: PLACE NEW FIBER CABINET ON COMMERCIAL FOR THE PURPOSE OF FEEDING THE  
DETAILED AREA PROVIDED WITH FIBER SERVICES  
 Street Address: 1130 W COMMERCIAL ST Tax Key No.: \_\_\_\_\_  
 - or -  
 Street: COMMERICAL From: MASON To: SUMMIT  
 Multiple Streets: \_\_\_\_\_

*(Department use only)*

Occupancy Type	Sub-Type	Location
<input checked="" type="checkbox"/> Permanent (\$40)	<input type="checkbox"/> Sandwich Board	<input type="checkbox"/> Sidewalk
<input type="checkbox"/> Temporary - max. 35 days (\$40)	<input type="checkbox"/> Tables / Chairs	<input type="checkbox"/> Terrace
<input type="checkbox"/> Amenity/Annual (\$40)	<input type="checkbox"/> Dumpster	<input type="checkbox"/> Roadway
<input type="checkbox"/> Blanket/Annual (\$250)	<input type="checkbox"/> POD / Container	
<input type="checkbox"/> Block Party (\$15)	<input type="checkbox"/> Obstruction / Other	

**Additional Requirements**

Plan/Sketch                       Certificate of Insurance                       Bond  
 Other: \_\_\_\_\_

**Traffic Control Requirements**       N/A

Contact Traffic Division (832-2379) 1 business day prior to any lane closure, or 2 business days prior to a full road closure.

<p><u>Type of Street:</u>      <u>Proposed Traffic Control:</u></p> <input type="checkbox"/> Arterial/CBD <input type="checkbox"/> City Manual Page(s) <input type="checkbox"/> Collector <input type="checkbox"/> State Manual Page(s) <input type="checkbox"/> Local <input type="checkbox"/> Other (attach plan)	<p>Additional Requirements:</p>
---	---------------------------------

Approved by: \_\_\_\_\_ Date: \_\_\_\_\_

- This permit approval is subject to the following conditions:**
1. Permittee is responsible to obtain any further permits that may be required as part of this occupancy.
  2. Permittee shall adhere to any plan(s) that were submitted to the City of Appleton as part of this application.
  3. This permit is subject to IMMEDIATE REVOCATION and/or issuance of a MUNICIPAL CITATION if conditions of the permit are not met.
  4. This permit is subject to IMMEDIATE REVOCATION if unfavorable traffic conditions develop during the period the occupancy is permitted.
  - 5.
  - 6.

This permit is issued to the applicant upon payment of the permit fee and is expressly limited to the location and type described herein. The applicant, in exchange for receiving this permit, warrants that all street occupancies will be performed in conformity to City ordinances, standards and policies, be properly barricaded and lighted, and be performed in a safe manner. By applying for and accepting this permit, the applicant assumes full liability and/or any costs incurred by the City for corrective work required to bring the subject area into compliance with said ordinances, standards, policies and permit conditions. No occupancy shall occur prior to approval of this permit by the Department of Public Works.

The Grantee shall guarantee at their expense, the repair or replacement of pavement, sidewalk and any other facilities within the public right-of-way damaged or destroyed by the Grantee or any sub-contractor working for them. The Grantee shall assume complete and full liability and responsibility, in accordance with existing ordinances and policies, in the event of injury or damage to persons or property resulting from their facilities within the public right-of-way.

APPROVED BY: \_\_\_\_\_ DATE: \_\_\_\_\_  
 (Department of Public Works)



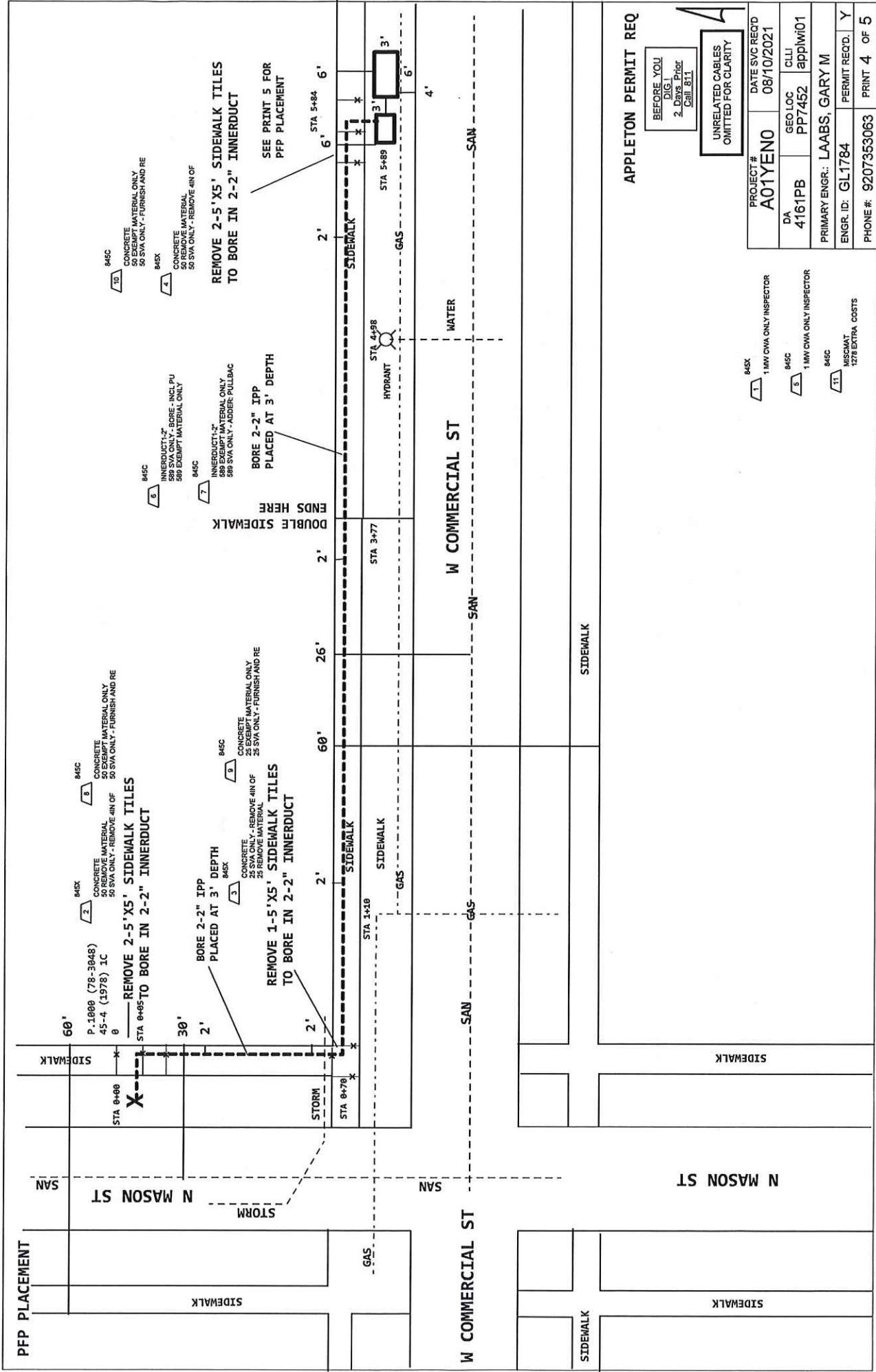

**APPLETON PERMIT REQ**

BEFORE YOU DIG, 2 Days Prior Call 811

UNRELATED CABLES OMITTED FOR CLARITY

PROJECT #	A01YENO	DATE SVC REQ'D	08/10/2021
DA	4161PB	GEO LOC	app1w101
PRIMARY ENGR.: LAABS, GARY M			
ENGR. ID.	GL1784	PERMIT REQ'D.	Y
PHONE #.	9207353063	PRINT	4 OF 5

1	845X	1 MW CWA ONLY INSPECTOR
5	845C	1 MW CWA ONLY INSPECTOR
11	845C	MISC MAT 12% EXTRA COSTS

AT&T Proprietary (Internal Use Only). Not for use or disclosure outside of AT&T companies except under written agreement.

**PPF PLACEMENT**

- 1 845C  
1 MW OWA ONLY INSPECTOR
- 2 822C  
1 MW OWA ONLY INSPECTOR

ATT 20'5"  
P.1000 (78-3048)  
45-4 (1978) 1C  
0

N MASON ST

STA 5+02

BKTH-1800  
105' SPAN

CLEAT 576 FIBER RISER  
822C  
1 PLACE AND CLEAT RISER CAB

SEE PRINT#4  
FOR 576 PLACEMENT

TO FIELD  
TO PRETR#5

W COMMERCIAL ST

N MASON ST

STA 3+84

BKTH-1800  
118' SPAN

LEAVE 120'  
PLACE SNOWSHOE  
P.918 (78-3047) ATT 20'8"  
45-4 (1978) 1C  
0

ORDER 288 FIBER ON  
ONE REEL

LEAVE 120'  
PLACE SNOWSHOE  
P.904 (78-3046) ATT 20'8"  
45-4 (1978) 1C  
0

3 (PPA) 845C 242'  
5802MR-288  
AP016,781-786  
H,7-12  
1928M,205-216  
C,25-288

4 (PPA) 822C 699'  
5802MR-288  
AP016,781-786  
H,7-12  
1928M,205-216  
C,25-288

2 845C  
5802MR-288  
242 MATERIAL ONLY  
242 SVA ONLY-PLACE ITEM IN

5 822C  
5802MR-288  
699 MATERIAL ONLY  
699 SVA ONLY-LASH CABLE/IN

HH 1308M  
HH-30X48X36 (2007) 845C  
2.5 X 4 X 3 = 30

N MASON ST

STA 1+73  
STA 1+51

BKTH-1800  
110' SPAN

FRC CHANGE ATT 21'3"  
P.818 (78-2004)  
45-4 (1978) 1C  
0

TO CO  
TO PRT#1

TO FIELD

W WINNEBAGO ST

N MASON ST

STA 0+00

BKTH-1800  
110' SPAN

2 (2007) 845C 298'  
5802MT24-350LP  
L607,525-528  
M,5-24

3 (PPA) 845C 766'  
5802MR-576  
AP016,781-786  
H,7-12  
1928M,205-216  
C,25-48  
D,49-336  
D,337-576

845C  
766 MATERIAL ONLY  
766 SVA ONLY-PLACE ITEM IN

KV<14.4KV  
APPLETON PERMIT REQ

BEFORE YOU  
DIG  
2 Days Prior  
Call 811

UNRELATED CABLES  
OMITTED FOR CLARITY

PROJECT#	A01YEN0	DATE SVC REQD	08/10/2021
DA	4161PB	GEO LOC	PP7452 applw01
PRIMARY ENGR.	LAABS, GARY M		
ENGR. ID:	GL1784	PERMIT REQD.	Y
PHONE #:	9207353063		
		PRINT	3 OF 5

1 (2007) 845C  
5802MT-024  
L607,525-528 NC  
(MH4D07,5-6) <A01YEN0> X,5-6  
(MH4D07,7-12) <A01YEN0> AP016,781-786  
(MH4D07,13-24) <A01YEN0> 1928M,205-216

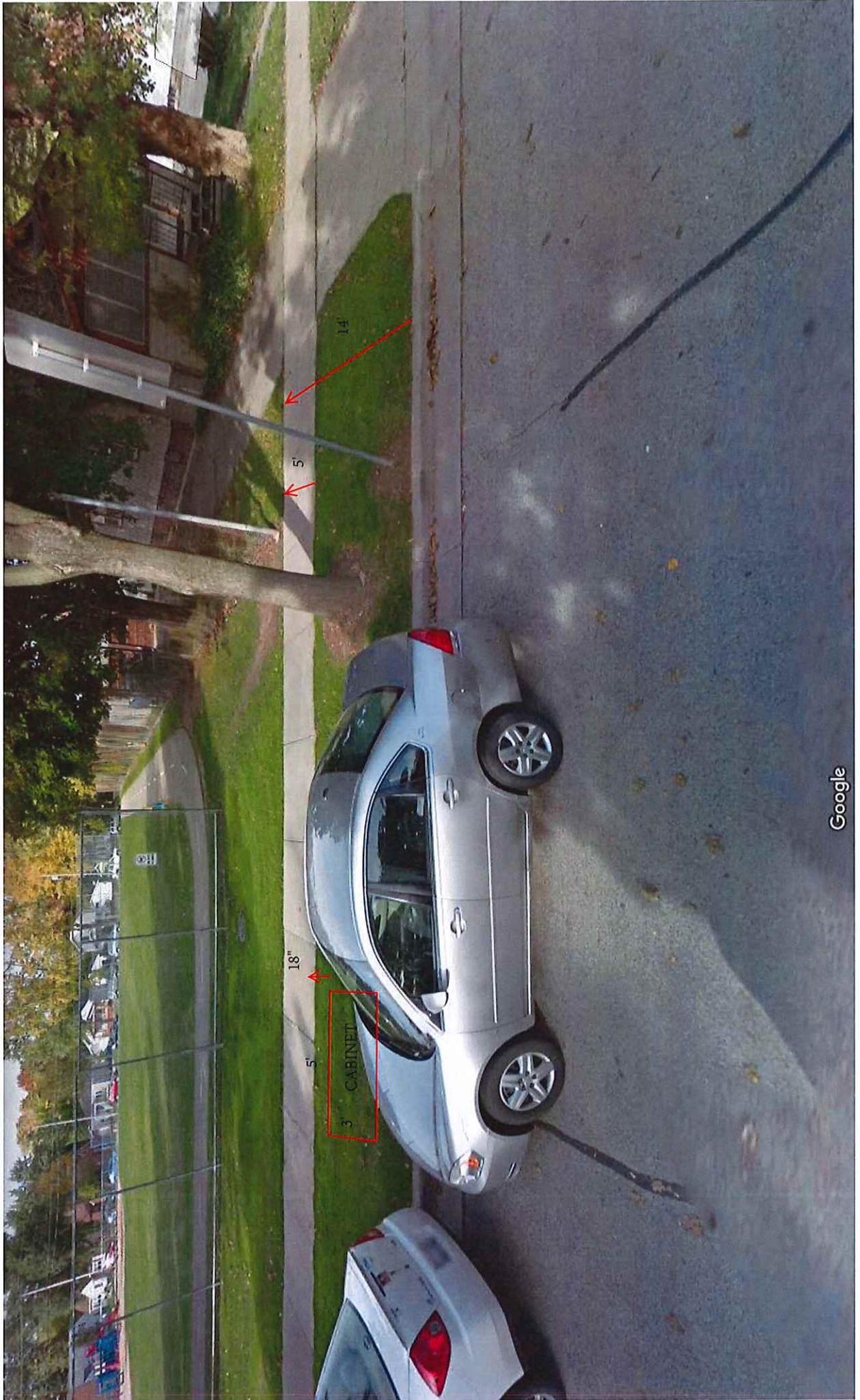

Google

