

# Southpoint Commerce Park Appleton, Wisconsin

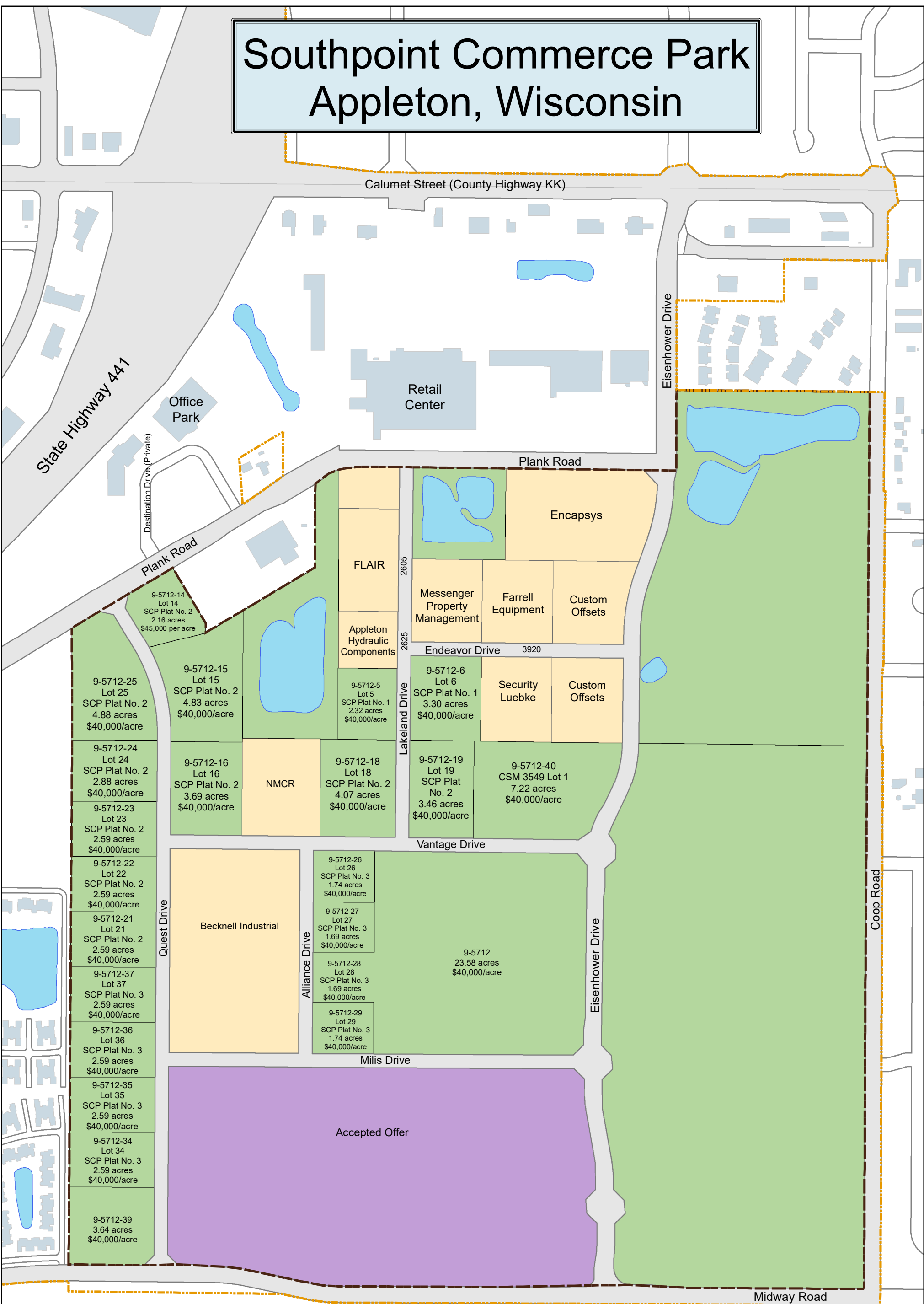

**Legend**

- For Sale (City Owned)
- Accepted Offer
- Privately Owned Parcels
- City Limits
- Park Boundary

0 250 500 1,000  
Feet  
N  
Prepared by City of Appleton  
Comm. & Econ. Dev. Dept. 11/2019